

Professional Audio **2017**



AEB Industriale s.r.l, founded in 1974 in Bologna, Italy, operates in the Professional Audio market under the brand dBTechnologies and is part of Pro Audio industry leader RCF Group.

AEB Industriale headquarters are located in Bologna where all dBTechnologies products are designed and developed.

Over the years, thanks to a policy of considerable investments in R&D, design and manufacturing technologies, dBTechnologies products

have gained substantial recognition for some groundbreaking technological innovations, as well as their inherent standards of quality.

In particular, dBTechnologies has been one of the industry's trailblazer in active speaker & digital amplifier technologies, while giving a major emphasis to details and design.

A constant research on new materials and technologies, together with the ability to create unique design solutions, are the key ingredients for an ever-

increasing market share and success.

In January 2016, the brand was distributed in more than 100 countries worldwide, providing installation companies, rental companies, sound designers and musicians with audio equipment combining Made in Italy design with top-quality sound performance.

dBTechnologies



Product Index

INGENIA Series.....	4	FLEXSYS Series.....	22	MINIBOX Series.....	32
INGENIA IG1T	Active Speaker	FLEXSYS F212	Active Speaker	MINIBOX L80D	Active Speaker
INGENIA IG2T	Active Speaker	FLEXSYS F315	Active Speaker	MINIBOX L160D	Active Speaker
INGENIA IG3T	Active Speaker	FLEXSYS FM8	Active Stage Monitor	MINIBOX K70	Active Speaker
INGENIA IG4T	Active Speaker	FLEXSYS FM10	Active Stage Monitor	MINIBOX K162	Active Speaker
		FLEXSYS FM12	Active Stage Monitor	MINIBOX K300	Active Speaker
ES Entertainment System.....	10	OPERA Series.....	24	READY 4 Mk2.....	34
ES 1203	Active Speaker	OPERA 10	Active Speaker	ARENA Series.....	36
ES 503	Active Speaker	OPERA 12	Active Speaker	ARENA 8	Passive Speaker
ES 802	Active Speaker	OPERA 15	Active Speaker	ARENA 10	Passive Speaker
LVX Series.....	16	B-Hype Series.....	26	ARENA 12	Passive Speaker
LVX XM12	Active Coaxial Monitor	B-Hype 8	Active Speaker	ARENA 15	Passive Speaker
LVX XM15	Active Coaxial Monitor	B-Hype 10	Active Speaker	ARENA SW15	Passive Subwoofer
LVX 8	Active Speaker	B-Hype 12	Active Speaker	ARENA SW18	Passive Subwoofer
LVX 10	Active Speaker	B-Hype 15	Active Speaker	OPERA P15 Passive Speaker.....	38
LVX 12	Active Speaker	SUB Series.....	28	HPA Amplifiers.....	38
LVX 15	Active Speaker	SUB 15H	Active subwoofer	ELECTRONICS.....	39
SIGMA Series.....	20	SUB 18H	Active subwoofer	ACCESSORIES.....	40
SIGMA S115	Active Speaker	SUB 615	Active subwoofer		
SIGMA S115F	Active Speaker	SUB 618	Active subwoofer		
SIGMA S215	Active Speaker	SUB 28D	Active subwoofer		
SIGMA S118	Active subwoofer	SUB 12D	Active subwoofer		
SIGMA S218	Active subwoofer				



INGENIA

Series

INGENIA **IG1T**
INGENIA **IG2T**
INGENIA **IG3T**
INGENIA **IG4T**

Professional Active Speakers



Cutting-edge technology with inspired ideas

The current panorama of active speakers with digital processing offers a significant amount of products with more or less advanced technologies and cutting-edge features. But it's only when those technologies are combined with inspired ideas that products are really able to change the scenario. That's exactly what INGENIA represents: a new synthesis of knowledge in acoustics, mechanics, power electronics, DSP programming and innovative materials combined to realize a simple idea: a range of portable active speakers compact, modular, flyable, with a user-friendly interface, able to recognize the presence of a second stacked speaker or a subwoofer and automatically setup to ensure best coverage, acoustic coherence and high sound pressure.

INGENIA is not a simple active speaker, not a column system, not a conventional line array. INGENIA is simply INGENIA: a new way of thinking about sound reinforcement in any kind of situation.

Professional Active Speakers

INGENIA Series

The INGENIA series consists of four models with a power ranging from 400W to 900W. They are equipped with premium low frequencies transducers: 6.5" for IG1T and IG4T, 8" for IG2T and 10" for IG3T. Compression drivers range from 1" for IG1T and IG2T to 1.4" for IG3T and IG4T.

IG1T

2-way Active Speaker 2x6.5" neo woofers, 1" comp. driver, 400W digipro® G3, 56 bit DSP, OLED display with control knob, digital steering coverage, infrared EPD (Element Position Detection) system. Flyable (with optional accessories). Dimensions: 195x536x271mm (7.68x21.10x10.67in), Weight 10.6Kg [23.37 lbs.]

IG2T

2-way Active Speaker 2x8" neo woofers, 1" comp. driver, 400W digipro® G3, 56 bit DSP, OLED display with control knob, digital steering coverage, infrared EPD (Element Position Detection) system. Flyable (with optional accessories). Dimensions: 228x646x315mm (8.98x25.43x12.40in), Weight 12.8Kg [28.22 lbs.]

IG3T

2-way Active Speaker 2x10" neo woofers, 1.4" comp. driver, 900W digipro® G3, 56 bit DSP, OLED display with control knob, digital steering coverage, infrared EPD (Element Position Detection) system. Flyable (with optional accessories). Dimensions: 280x806x393mm (11.02x31.73x15.47in), Weight 22.24Kg [49 lbs.]

IG4T

2-way Active Speaker 4x6.5" neo woofers, 1.4" comp. driver, 900W digipro® G3, 56 bit DSP, OLED display with control knob, digital steering coverage, infrared EPD (Element Position Detection) system. Flyable (with optional accessories). Dimensions: 195x956x271mm (7.68x37.64x10.67in), Weight 19.4Kg [42.77 lbs.]

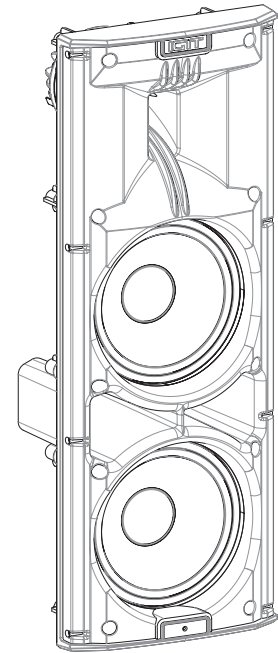



CEC - Controlled Energy Coverage: new horn concept

The horn of INGENIA is horizontally symmetric and vertically asymmetric. The horizontal dispersion is wide and constant; the vertical dispersion is narrow in the upper part and wide in the lower.

This is because the INGENIA speakers are designed to work in single or stacked configuration with the two horns coupled one upon the other by overturning the upper speaker on the lower one.

Digipro® G3 Amp Modules

All models comes with the new generation of exclusive digital amplifiers Digipro® G3, which deliver a power that you can't expect from such a small amplifier. They also features an exceptionally lightweight design, SMPS technology with PSU auto-range and a very remarkably efficiency so that there is no need of cooling fans.

User-Friendly Interface

The INGENIA series is incredibly simple to set up. Just connect the speaker to mains through the new Neutrik® NAC3PX on rear panel, connect the audio using the balanced XLR connectors, select MIC or LINE input, adjust the volume and you're done. Leave everything else to the powerful DSP.

Configuration Wizard

The advanced interface guides the user since he turns on the speaker, asking for information on the use and the type of configuration he is going to use. The system automatically sets up, in order to quickly meet the demand. Of course he can change all the choices made at any time by either restarting the wizard, or manually changing the specific parameter.

The system even allows you to choose from a variety of configurations with one or more INGENIA speakers and combinations with one or more subwoofers, choosing among several dBTechnologies subwoofer presets.

A powerful processing

Behind the simple interface there is a cutting-edge processing, which manages mixer, power amplifiers, coverage steering and customize many other functions such as EQs, levels as well as all input devices. The OLED display, visible even in the sunlight, is mounted behind an elegant smoked screen and provides all the necessary information to the total system control. All editing operations are carried out through a single rotary encoder with switch, making them extremely easy and error-free.

As mentioned above, the INGENIA is equipped with the new Neutrik® NAC3PX mains connector that provides a safe connection with secure locking system.

The integrated USB mini port allows the user upgrade the firmware of the INGENIA, ensuring that the speaker is always updated to the latest version (download from www.dbtechnologies.com).



Professional Active Speakers

Digital steering coverage

This is not the first time that dBTechnologies R&D designs speakers with asymmetric horns. Even on the famous OPERA series were adopted technical solutions of this type, but now the mechanical design of the waveguide is supported by a sophisticated processing in order to steer the coverage depending on the presence or not of the second speaker. The result is to ensure maximum intelligibility and transparency in the whole frequency range.

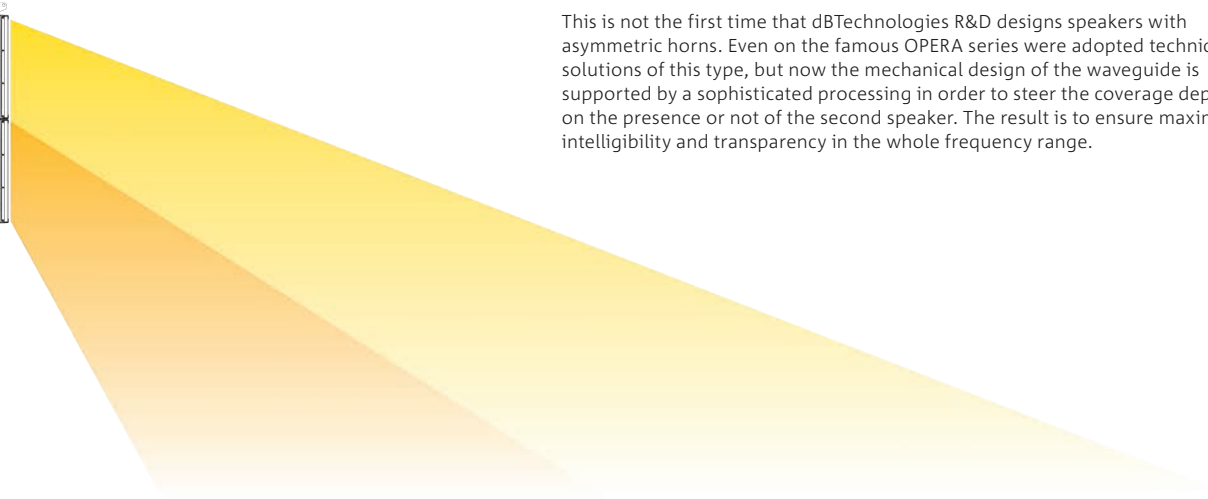
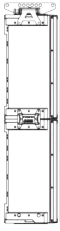

EPD - Element Position Detection

But now some questions arise: how to instruct the DSP of INGENIA that there is a speaker on it, that this speaker is the right one and that is correctly stacked? Infrared technology offers the solution.

Infrared Communication

The INGENIA speakers are equipped with an “infrared-core handle” on top, which contains a system of infrared communication. When a second INGENIA speaker is stacked on another, there is a quick exchange of information between the two DSPs: the first becomes the master, the second the slave.

Self-rotating display

Since the INGENIA speakers are made to work in “reversed stacked configuration”, the OLED display is equipped with a self-rotation device that feels when the speaker is upside down, ensuring maximum intelligibility in every position, thanks to an integrated accelerometer.

This infrared detection system does not suffer the presence of sunlight, so it can be used safely in any outdoor environment without any lack of communication.

Control Mirroring

When two INGENIAs are used in stacked configuration, the speakers work as a unique system. Volume and DSP processing are unified. In other words, when the user turns the volume up or down on the master speaker, this change will automatically be mirrored on the slave.



Lightweight and heavy-duty enclosure

The housing is made with a new type of reinforced polypropylene that has a very elegant look and a fine finish. The enclosure surface is then immune to knocks and scratches and fully resistant to water and moisture. Internally, there is an aluminium reinforcing structure that, in addition to dampen vibrations and enhance the acoustic characteristics of the speaker, greatly improves the box toughness. Finally there is a hardware metal reinforcement for the fly-bar hidden inside the cabinet.

A magnetic rain cover is also available, in order to rapidly protect the speaker from rain, especially in outdoor events, whether the speaker is upright or upside down.

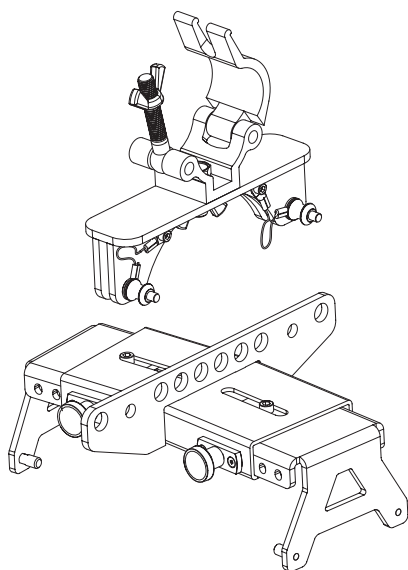
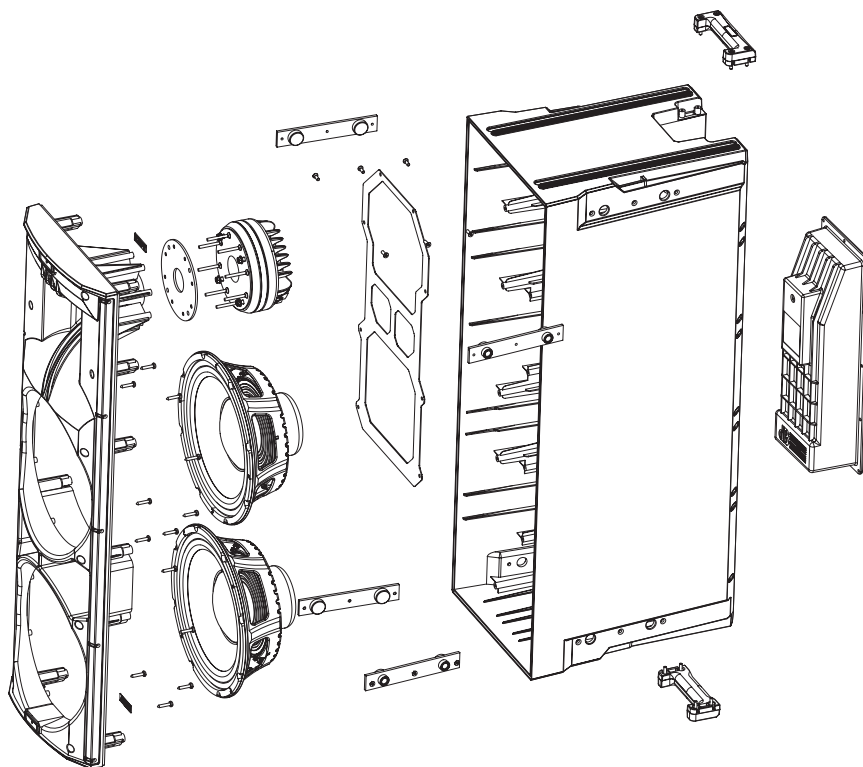

Speakers with neodymium magnet

All transducers in the INGENIA series feature neodymium magnets, improving reliability, performance and contributing to contain the overall weight of these modules. The weights, despite the huge technology contained in these speakers, range from 10.6Kg (23.37lbs.) of IG1T to 22.24Kg (49.03lbs.) of IG3T, making the INGENIA absolutely portable and easy to handle.

Flying configuration

All INGENIA speakers are equipped with a pole-mounting hole (D36mm). But in addition to the use on pole or speaker stand, there is a new fly bar (DRK-IG) adaptable to all speakers of the series. This bar allows the user to hang up to two speakers in vertical array. Of course in this case two linking plugs are needed. Then the user will choose the appropriate processing preset and the DSP will set up everything so that you get all benefits of a line source system. Finally there is an additional accessory to mount the fly-bar to truss couplers and thus locking the aiming even in case of wind.

Unique speaker lock system

The locking system of the INGENIA is extremely rugged and reliable and the LP-IG accessory fits all the 4 INGENIA models. Moreover, to ensure the speakers to be perfectly aligned before locking the clamps, there are some feet and recessions on the top and the bottom of the enclosure. This solution avoids incorrect operations in any way and ensures perfect alignment, maximum safety and a longer life of the mechanical parts.



Professional Active Speakers

	IG1T	IG2T	IG3T	IG4T
Speaker Type	2-Way Active Speaker	2-Way Active Speaker	2-Way Active Speaker	2-Way Active Speaker
Frequency Response [- 10dB]	85 - 20.000 Hz	59- 20.000 Hz	53 - 20.000 Hz	74- 20.000 Hz
Frequency Response [- 6dB]	92 - 19.200 Hz	63- 19.200 Hz	57- 19.200 Hz	88 - 19.200 Hz
Max SPL	128 dB	128 dB	132 dB	132 dB
HF	1"	1"	1.4"	1.4"
HF voice coil	1.4"	1.4"	3"	3"
Directivity (HxV) [- 6dB]	100 x 80° (+15°/- 65°)	100 x 80° (+15°/- 65°)	110 x 90° (+20°/- 70°)	110 x 90° (+20°/- 70°)
HF Type	Neodymium compression driver	Neodymium compression driver	Neodymium compression driver	Neodymium compression driver
Horn	Vertical asymmetric	Vertical asymmetric	Vertical asymmetric	Vertical asymmetric
Crossover Frequency	2100 Hz	1900 Hz	1100 Hz	1100 Hz
LF	2x6.5"	2x8"	2x10"	4x6.5"
LF voice coil	1.5"	2"	2.5"	1.5"
LF Type	Neodymium	Neodymium	Neodymium	Neodymium
Amp Technology	Digipro® G3	Digipro® G3	Digipro® G3	Digipro® G3
Amp Class	Class-D	Class-D	Class-D	Class-D
RMS Power	400 Watt	400 Watt	900 Watt	900 Watt
Peak Power	800 Watt	800 Watt	1800 Watt	1800 Watt
Controller	DSP 56 bit	DSP 56 bit	DSP 56 bit	DSP 56 bit
AD/DA converter	24bit/48kHz	24bit/48kHz	24bit/48kHz	24bit/48kHz
DSP Settings	Acoustic correction, HPF, Anti-feedback filters, delay	Acoustic correction, HPF, Anti-feedback filters, delay	Acoustic correction, HPF, Anti-feedback filters, delay	Acoustic correction, HPF, Anti-feedback filters, delay
Limiter	Dual Active Peak, RMS, Thermal	Dual Active Peak, RMS, Thermal	Dual Active Peak, RMS, Thermal	Dual Active Peak, RMS, Thermal
User Interface	OLED display + rotative knob w/button	OLED display + rotative knob w/button	OLED display + rotative knob w/button	OLED display + rotative knob w/button
Self-rotating display	Yes	Yes	Yes	Yes
Positioning	EPD (Element Position Detection)	EPD (Element Position Detection)	EPD (Element Position Detection)	EPD (Element Position Detection)
Advanced Features	Yes	Yes	Yes	Yes
Input	1 x Combo (XLR + TRS) 1 x PowerCON TRUE1	1 x Combo (XLR + TRS) 1 x PowerCON TRUE1	1 x Combo (XLR + TRS) 1 x PowerCON TRUE1	1 x Combo (XLR + TRS) 1 x PowerCON TRUE1
Output	1 x XLR link 1 x PowerCON TRUE1	1 x XLR link 1 x PowerCON TRUE1	1 x XLR link 1 x PowerCON TRUE1	1 x XLR link 1 x PowerCON TRUE1
USB connector	mini USB	mini USB	mini USB	mini USB
Housing	Polypropylene PP reinforced	Polypropylene PP reinforced	Polypropylene PP reinforced	Polypropylene PP reinforced
Grille	FULL /Invisible screws	FULL/Invisible screws	FULL/Invisible screws	FULL/Invisible screws
Flyable	Yes	Yes	Yes	Yes
Handles	1x on top / 1x on bottom	1x on top / 1x on bottom	1x on top / 1x on bottom	1x on top / 1x on bottom
Pole Mount	Standard D36mm	Standard D36mm	Standard D36mm	Standard D36mm
Width	195 mm (7.68 in)	228 mm (8.98 in)	280 mm (11.02 in)	195 mm (7.68 in)
Height	536 mm (21.10 in)	646 mm (25.43 in)	806 mm (31.73 in)	956 mm (37.64 in)
Depth	271 mm (10.67 in)	315 mm (12.40 in)	393 mm (15.47 in)	271 mm (10.67 in)
Weight	10.8Kg (23.81 lbs.)	12.8Kg (28.22 lbs.)	20.8Kg (45.86 lbs.)	18.2Kg (40.12 lbs.)

ES 1203

ES 503

ES 802



ES 1203

TRI-AMPED DIGITAL ACTIVE STEREO SYSTEM

2400 W PEAK POWER

LAST GENERATION DIGIPRO G4 AMP WITH PFC

USER-FRIENDLY DSP INTERFACE

**3 CONFIGURATION MODES
(MONO, STEREO OR DOUBLE COLUMN)**

ON-BOARD 5 CHANNEL MIXER

BLUETOOTH® AUDIO RECEIVER

DIGITAL STEERING PRESETS (FAR/NEAR)

3 INPUT CHANNEL MODES (MIC/INSTR/LINE)

**CUSTOMIZABLE BALANCED OUTPUT CHANNEL
(LINK OUT/AUXILIARY)**

ULTRA-WIDE COVERAGE

ES is the first dBTechnologies' Entertainment System series: complete plug-and-play column systems, equally multifunctional, portable, space-saving and user-friendly.

Now ES family grows stronger with ES 1203, a complete stereo sound system encompassing its predecessors' versatility with striking SPLs (the system features a 2400W last-generation power amp) and an impressively coherent throw pattern.



Tri-Amp Entertainment Stereo System

The most powerful complete PA system

ES1203 is a 3-amped stereo sound system composed by 2 passive wooden tops and one active wooden subwoofer equipped with 2x12" woofers.

The sub hosts last-generation Digipro® G4 2400W Peak Amp. A powerful DSP (controlled by an intuitive user interface placed on the top of the sub) manages all function of the 5-channel on-board digital mixer, as well as the system configurations.

Ultra-wide coverage

Each top satellite is equipped with 4x 4" mid-woofers, whose alignment allows an asymmetrical vertical coverage (thanks to the Logarithmic Curved Column Array technology). The unique design of phase plugs widens the horizontal coverage and guarantees a perfect intelligibility. Moreover, on board DSP allows users to choose among 3 Configuration Modes (Mono, Stereo or Double Column) and 2 different Steering Modes (Far and Near). This way, the system adapts to all kind of environments and guarantees the best throw pattern.



ES 1203

Speaker Type	3-amped Stereo System with two full-range tops and one semi-horn loaded subwoofer
Frequency Response [-10dB]	35 - 20.000 Hz
Max SPL	132 dB
MF-HF	8x 4", v.c. 1"
MF-HF Type	Neodymium
LF	2x 12", v.c. 2.5"
LF Type	Ceramic
Directivity	97x60°
Amp Technology	Digipro® G4
Amp Class	Class-D
Peak Power	2400 W
Controls	1x OLED Display with rotary encoder w/button 1x Audio signal monitoring LED 1x USB port (service data)
Power Supply	Full-range with PFC
Power Connection	VDE socket
Cooling	Convection
Controller	DSP 56 bit
Converter AD/DA	24 Bit/48 kHz
Limiter	Peak, RMS, Thermal
Crossover Frequency LF-MF	160 Hz
Digital Steering	Far/Near
Input Channels	1x Mic/Instrument Combo (XLR/Jack) 2x Mic/Line Combo (XLR/Jack) 1x Bluetooth® built-in receiver
Mix Output	1x XLR balanced output
Housing (Subwoofer)	Plywood with full metal grille
Housing (Tops)	Plywood with full metal grille
Pole Mount	Ø36 mm (M20 thread)
Handles on bubwoofer	1x on top, 1x lateral side
Dimensions WxHxD (Tops)	110x460x160 mm - 4.33x18.11x6.30 in
Dimensions WxHxD (Subwoofer)	360x680x545 mm - 14.17x26.77x21.46 in
Weight (1 Top)	3.3Kg - 7.27lbs.
Weight (Subwoofer)	29.3Kg - 64.59lbs.

Fast-lock top speakers connection

Top satellites can be used separately in a Stereo configuration (placed on tripods or installed with WB-44 accessory) or connected together in a Mono Configuration: the enclosure of the two satellites embeds a metal lock connection system, which assures perfect top-to-top matching without the risk of incorrect assembly and includes the electrical connection between the two tops. One of the two satellites receives the powered signal from the subwoofer through a 4-poles male Speakon™ connector and relaunch the audio to the other top.



On-board 5-channel Mixer

ES1203 features an on board 5 channel mixer: the first channel features a Mic/Instrument balanced/unbalanced combo connector with an adjustable anti-feedback filter, impedance compensation and microphone gain with 3 positions (0, +10, +20dB). The second and third channels are Mic/Line inputs with balanced/unbalanced combo connector. This allows the system to manage up to 3 mic lines at a time.

The balanced Aux/Mix output can be used as a direct link, or, alternatively, as an Aux output. In this case, you can actually feed a stage monitor or another speaker for which a custom separate mix is needed. When in double column mode, this output acts as a source of a second ES system providing left or right content.



Integrated Stereo Audio Bluetooth® Module

ES1203 is equipped with a built-in Bluetooth® module, which receives stereo audio from devices such as mobile phones, tablets or any other audio device with a Bluetooth® connection. The system manages the Bluetooth® audio autonomously as a separate channel.

User Friendly OLED display

ES1203 is incredibly simple to set up. Users are guided step-by-step to configure the system according to the application thanks to the advanced graphical interface. In fact, the OLED display allows to enter the heart of the system, recall configuration presets, adjust levels, EQ and create a pre/post gain mix for different purposes. A rotary encoder with a switch allows to control any operation easily and quickly.

A Powerful Subwoofer

The semi-horn loaded subwoofer houses 2x 12" woofers and the amp module, and the OLED display with system controls. In addition to the input connectors and controls of the user-interface, there are two Speakon outputs and the power connector. The enclosure, sturdy and stylish, is made of plywood coated with a durable scratch-resistant black coat, which makes it truly road-ready. The dolly DO-ES1203 allows to transport the system quickly and smoothly.

Clean and elegant in Mono Mode

When used in Mono mode, the system can be completed with DP-ES1203, a designed wooden pole which levels out the overall design resulting in an elegant, unobtrusive look which perfectly fits permanent installations.

The ES 1203 bundle is composed by a subwoofer with its cover, two tops with bag, a D35mm pole, 2 Speakon cables (2.5 mt and 7 mt), power supply cable.

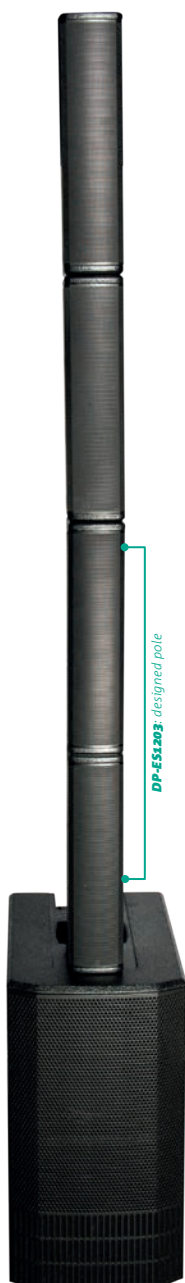

Tri-Amp Entertainment Stereo System

ES 503



Bluetooth®

ES 503 is the first born of brand new Entertainment System series, specifically created by in order to pack its long time active speaker expertise into a multifunctional, portable, space-saving, user-friendly yet powerful system.

A complete 3-element system which adapts to several uses (and thousands of different users), thanks to a built-in digital mixer, an OLED display user interface and a Bluetooth® audio receiver.



ES 503

Speaker Type	3-amped Stereo System with two full-range tops and one subwoofer
Frequency Response [-10dB]	37 - 15.000 Hz
Max SPL	121 dB
MF-HF	8x 3"
MF-HF Type	Neodymium
LF	12"
Directivity	95x65°
Amp Technology	Digipro® G3
Amp Class	Class-D
Power Amp	1000 W
Controls	1x OLED Display with rotary encoder w/button 1x Audio signal monitoring LED 1x USB port (service data)
Power Supply	SMPS with PSU Auto-range
Power Connection	VDE socket
Cooling	Convection
Controller	DSP 56 bit
Converter AD/DA	24 Bit/48 kHz
System Presets	Factory presets + User defined
Limiter	Dual Active, Peak, RMS, Thermal
Crossover Frequency LF-MF	206 Hz
Mic/Instrument Channel	1x Combo (XLR/Jack) balanced/unbalanced input
Line Channels	2x Combo (XLR/Jack) balanced/unbalanced inputs
Media Channel	1x Bluetooth® built-in receiver
Mix Output	1x XLR balanced output
Housing (Subwoofer)	15mm Black Painted Birch Plywood
Housing (Tops)	Polypropylene PP
Pole Mount	Ø25 mm (M20 thread)
Handles on subwoofer	1x lateral side
Dimensions WxHxD (Tops)	95x360x137 mm – 3.74x13.98x5.39 in
Dimensions WxHxD (Subwoofer)	465x400x430 mm - 18.3x15.7x16.9 in
Weight (1 Top)	1.9Kg – 4.19lbs.
Weight (Subwoofer)	16.4Kg – 36.16lbs.

ES503 is a 1000W 3-amped sound system composed by 2 slave 4x 3" full-range tops and 1 master 12" subwoofer. The sub hosts a Digipro® G3 amp module with auto-range PSU and a 3-channels mixer with Bluetooth connection. A powerful DSP manages all function of the on-board digital mixer, making the ES503 a real gem in terms of sound performance and versatility.

The ES503 bundle is composed by a subwoofer, two tops, a D25mm pole and a Speakon/Speakon cable to connect the sub to the top. The speaker pole is splittable in two segments for easy transport.

The system also provides a large group of accessories, such as 2 D25mm tripod stands with a dedicated transport bag, a bag to carry 2 tops and a D25mm pole, a bag for the 12" subwoofer, a trolley, a cable kit with two 7m Speakon/Speakon cables. A stereo kit comprising 2 tripods + 2 7m Speakon/Speakon cables and a transport kit comprising 1 sub bag + 1 top bag + 1 trolley are also available.

ES 1203 and ES 503 System Configurations

Both ES1203 and ES503 allows 3 different configurations suitable for hundreds of different occasions:

Option 1: **SINGLE COLUMN MODE**, 1x stand pole

Option 2: **SINGLE STEREO MODE**, 2x tripod or 1x stand pole and 1x tripod

Option 3: **DOUBLE COLUMN MODE**, Double Column Mode 2 ES1203 or ES503 systems in single column mode

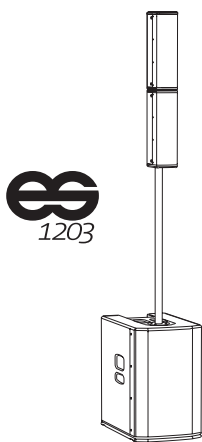

Option 1: SINGLE COLUMN MODE, 1x stand pole

In the first option the two satellites are connected top-on-top and are placed on the subwoofer through the supplied pole. The system is used in mono so all inputs are routed to both outputs in mono. Of course the user can adjust volumes, 3-band EQ and send a second mix with different levels to the AUX/MIX output.

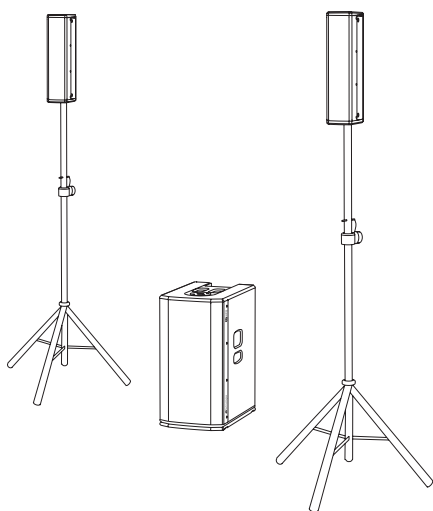
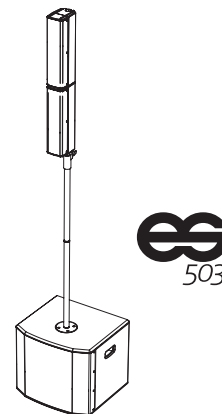

Option 2: SINGLE STEREO MODE 2x tripods or 1x stand pole and 1x tripod

This second option implies the use of two tripods and two Speakon-Speakon cables to connect the subwoofer to the tops placed on tripods. The system is in stereo: The Mic/Instrument input is assigned to both channels; CH1/LINE L (and Bluetooth® L) is assigned to Output L; CH2/LINE R (and Bluetooth® R) is assigned to Output R. Of course the user can adjust volumes and EQ. He can also prepare a second mix with different levels for the AUX / MIX output.

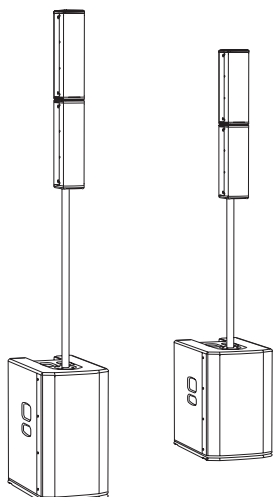
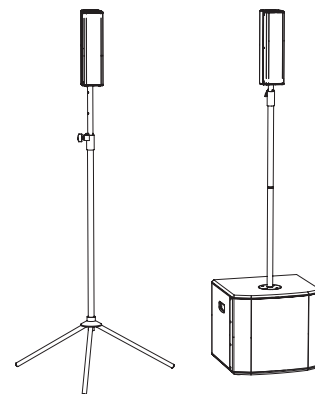

Option 3: DOUBLE COLUMN MODE, 2x ES 1203 or ES 503 in single column mode

The third option uses two ES 1203 or ES 503 systems in single column mode: one of the two becomes the master for the second, feeding the signal thanks to the integrated balanced output channel.

This way, both system are driven by the master's on-board mixer and any setup is guided through the master's OLED display.

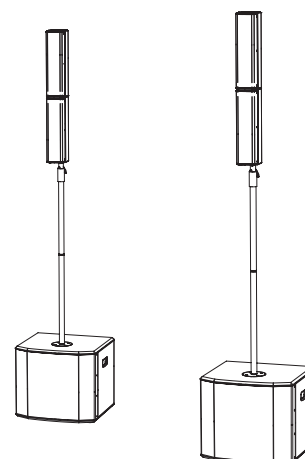

Bi-Amp Entertainment Portable System

ES 802

ES 802 is a bi-amped system combining power, extremely coherent coverage, excellent acoustic performance, easy transport and set up.

The powerful DSP and the particular flexibility of the inputs also ensure a great versatility; that's why ES 802 is the perfect solution for performers requiring small-sized plug and play systems providing a lusty acoustic performance.

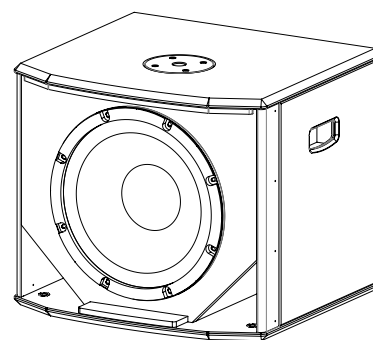

Great versatility

The 2 satellites of ES 802 have been designed using 4x 3" transducers ensuring a coherent coverage in every environment. The subwoofer houses a particularly powerful amplification section (1200 W for ES 802) and is equipped with a 12" woofer, ensuring a low frequencies consistency which you wouldn't expect from such a compact system.

The powerful DSP of ES 802 system provides 8 configurations, allowing to digitally equalize the audio signal according to different usage needs. The system allows to input both a connection from a mixer (line level) and a microphone connection. The balanced "LINK" output allows to create bigger ES systems or to feed the mix to any other system.

ES 802

Speaker Type	bi-amped system with two full-range tops and one subwoofer
Frequency Response [-10dB]	35 - 15.000 Hz
Max SPL	124 dB
HF	8x 3"
HF Type	Neodymium Woofers with phase plug
LF	1x 12"
Directivity [HxV]	95x65°
Amp Technology	Digipro® G3
Amp Class	Class-D
Power Amp	1200 W
Controls	1x Encoder (8 preset equalisations)
Power Supply	SMPS with PSU Auto-range
Power Connection	VDE socket
Cooling	Convection
Controller	DSP 56 bit
Converter AD/DA	24 Bit/48 kHz
System Presets	8 Factory presets + User defined
Limiter	Dual Active, Peak, RMS, Thermal
Crossover Frequency LF-HF	206 Hz
Mic/Instrument Channel	1x Combo (XLR/Jack) balanced/unbalanced input
Line Channels	1x RCA stereo input
Mix Output	1x XLR balanced output
Housing (Subwoofer)	15mm Black Painted Plywood
Housing (Tops)	Polypropylene PP
Pole Mount	Ø25 mm (M20 thread)
Handles on subwoofer	1x lateral side
Dimensions WxHxD (Tops)	95x360x137 mm - 3.74x13.98x5.39 in
Dimensions WxHxD (Subwoofer)	465x400x430 mm - 18.3x15.7x16.9 in
Weight (1 Top)	1.9Kg - 4.19lbs.
Weight (Subwoofer)	16.4Kg - 36.16lbs.





LVX **XM12**

LVX **XM15**

LVX **8**

LVX **10**

LVX **12**

LVX **15**

Professional Digital *Active Speakers & Monitors*

LVX XM12 & LVX XM15

Compact, powerful & road ready

LVX tour series family grows bigger with LVX XM professional stage monitors. Just like the other members of the LVX family, these active wedges respond to all those live music and touring requirements where sound reinforcement systems must be lightweight, portable, road resistant and easily adaptable to different stage necessities.

Equipped with heavy duty components and featuring an advanced coaxial horn design, LVX XMs wedge deliver a powerful yet clear sound quality in spite of their compact design, raising the bar for intelligibility, definition and ease of use.

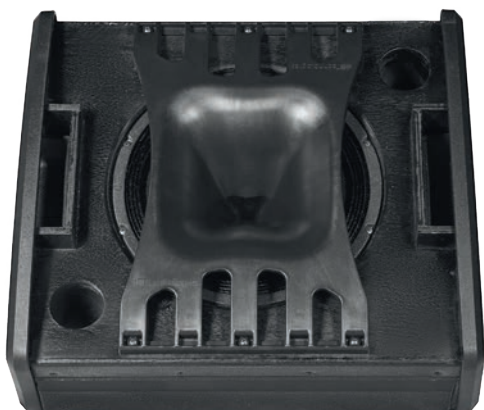

Enhanced coaxial horn design

LVX XM's design enhance the benefits of coaxial horn wedges concept. dBTechnologies designed a horn that not only shape high frequencies' directivity, but also acts as a phase plug for the woofer, boosting and lighting up the vocal band thanks also to the advanced DSP featuring FIR filters processing.

As a result, not only the horn contributes to deliver a bright audio performance with a uniform throw pattern, but it also reduces the overall dimensions of the system and protects the internal components, reinforcing the cabinet structure.

Active Coaxial Stage Monitors



8 preset equalizations for all stage requirements

LVX XM monitors feature an advanced DSP offering eight variable presets in order to easily adapt to different stage requirements and to the varying demands of vocalists, instrumentalists as well as audio playback applications.

The cabinets are constructed in sturdy plywood with a black PVC coating and comes with 2 integrated side handles allowing easy transport and stage set up operations. A pole mount cup on one side allow to put the system on a pole for vertical use (eg. as drummer monitoring or for audio playback applications).



LVX XM12



LVX XM15

Speaker Type	2-Way Coaxial Active Stage Monitor	2-Way Coaxial Active Stage Monitor
Frequency Response [- 6dB]	69 - 17.800 Hz	58 - 17.800 Hz
Max SPL	127 dB	128 dB
HF	1" Exit , 1.4" v.c.	1" Exit , 1.4" v.c.
Directivity [H x V]	90 x 70°	90 x 70°
LF	12", 2.5" v.c.	15", 2.5" v.c.
Amp Technology	Digipro® G3	Digipro® G3
Amp Class	Class-D	Class-D
RMS Power	600 W	600 W
Peak Power	1200 W	1200 W
Power Supply	SMPS with PSU Auto-range	SMPS with PSU Auto-range
Power Connection	PowerCon In / Link	PowerCon In / Link
Cooling	Convection	Convection
Controller	DSP 56 bit	DSP 56 bit
Converter AD/DA	24 bit/48 kHz	24 bit/48 kHz
System Presets	8 positions	8 positions
Limiter	Peak, Thermal, RMS	Peak, Thermal, RMS
Advanced DSP Function	Linear Phase FIR filters	Linear Phase FIR filters
Controls	Rotary 8 positions, MIC/LINE switch	Rotary 8 positions, MIC/LINE switch
Mains Connections	PowerCON in/link	PowerCON in/link
Signal Input	1x Combo IN (XLR/Jack)	1x Combo IN (XLR/Jack)
Signal Output	1x XLR link OUT	1x XLR link OUT
USB Connector	mini USB B-Type (service only)	mini USB B-Type (service only)
Housing	Plywood with black PVC cover	Plywood with black PVC cover
Grille	Metal black painted	Metal black painted
Handles	2, chassis-integrated	2, chassis-integrated
Pole mount	D36 mm	D36 mm
Width	515 mm (20.28 in)	640 mm (25.19 in)
Height	460mm (18.11 in)	460 mm (18.11 in)
Depth	370 mm (14.57 in)	370 mm (14.57 in)
Weight	20.1 kg (44.31 lbs)	22.3 kg (49.16 lbs)



LVX 8, LVX 10, LVX 12 & LVX 15

Excellent pedigree. Fit for every time

LVX active loudspeakers series is the answer to all those fixed installations and live music requirements where sound reinforcement systems must be lightweight, stylish, portable, powerful and in line with the highest professional standards. Coming from the experience gained in designing touring products as the renowned DVX series, the new LVX series offers smart solutions with a special attention to the needs of fixed and portable installations.

Advanced Technology

The LVX series uses DIGIPRO® series digital amplifiers with powers ranging from 400W (LVX 8 and 10) to 800W PRG (LVX 12 and 15). These highly efficient amplifiers provide high power, limited weight and are totally silent due to the low thermal dissipation and no cooling fans required.

The digital preamp with DSP controls audio crossover, frequency response, dual active peak-RMS-thermal limiter, and acoustic alignment. A selector enables to select one of two different equalizations - "FLAT" or "PROCESSED" - to provide the right sound in any occasion.



Elegance yet strength

The enclosure is made of robust 12mm plywood with a look very elegant and refined. The scratch-resistant finishes are available in both black and white. All models are equipped with handles for easy transport. The LVX 8 and 10 have a single handle on top; the LVX 12 and 15, in addition to the handle on the top, have a pair of handles on sides. In case of installation where you want to keep as much as possible a stylish and sober look, the white installation version of all the four models comes without the pole mount cup and the handles, providing a very transparent look.

A D36mm pole mount cup on the bottom allows all LVX speakers to be placed on poles or tripods, so as to be used as portable sound systems for any live music applications.



Impeccable Sound

The voicing of these speakers is very linear and designed to for any audio content, such as speech, background or live music, multimedia contents, etc., respecting their characteristics and dynamic response, and with a high level of performance. Four models available: LVX 8, 10, 12 and 15.

The dispersion of the constant directivity horn is symmetric and rotatable in order to keep the same coverage in case of horizontal use. This is particularly valued even in case of use as a stage monitor, configuration possible thanks to the rear angle of 45°.

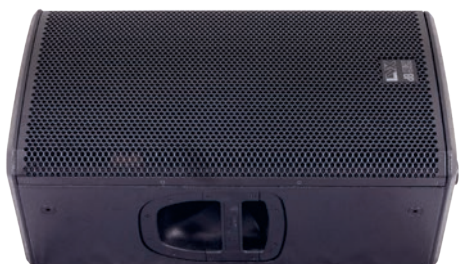

Digital Active Speakers

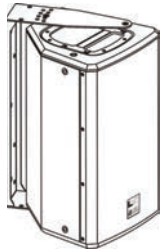
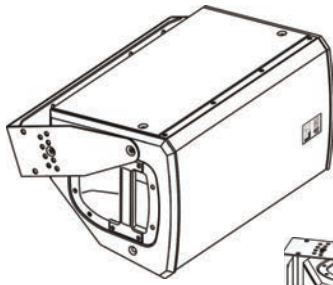

Versatility at its maximum level

There are two types of wall-mounting brackets: one for vertical installation, especially studied for live applications or truss mounting, with variable pan-tilt options (a pole mount cup is included as a stand adapter). The second is suggested for horizontal permanent installations, where you can easily change tilt position.

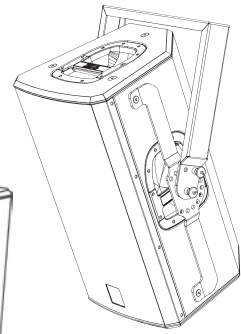

LVX 8



LVX 10

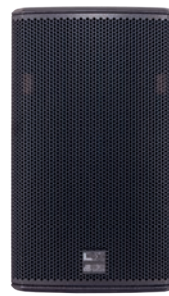

LVX 12



LVX 15

Speaker Type	2-Way Active Speaker	2-Way Active Speaker	2-Way Active Speaker	2-Way Active Speaker
Frequency Response [- 10dB]	65 - 20.000 Hz	60 - 20.000 Hz	55 - 20.000 Hz	49 - 20.000 Hz
Frequency Response [- 6dB]	80 - 19.000 Hz	70 - 19.000 Hz	62 - 19.000 Hz	54 - 19.000 Hz
Max SPL	121 dB	125 dB	127 dB	128 dB
HF	1", 1.5" v.c.	1", 1.5" v.c.	1", 1.5" v.c.	1", 1.5" v.c.
Directivity	90 x 70°	90 x 70°	90 x 40°	90 x 40°
Horn	Rotatable CD Horn	Rotatable CD Horn	Rotatable CD Horn	Rotatable CD Horn
LF	8", 1.5" v.c.	10", 2" v.c.	12", 2" v.c.	15", 2" v.c.
Amp Technology	Digipro® G2	Digipro® G2	Digipro® G2	Digipro® G2
Amp Class	Class-D	Class-D	Class-D	Class-D
PRG Power	400 W	400 W	800 W	800 W
Peak Power	800 W	800 W	1600 W	1600 W
Controller	DSP 56 bit	DSP 56 bit	DSP 56 bit	DSP 56 bit
AD/DA Converter	24bit/48kHz	24bit/48kHz	24bit/48kHz	24bit/48kHz
System Presets	Flat, Processed	Flat, Processed	Flat, Processed	Flat, Processed
Limiter	Dual Active Peak, RMS, Thermal	Dual Active Peak, RMS, Thermal	Dual Active Peak, RMS, Thermal	Dual Active Peak, RMS, Thermal
Crossover Frequency LF-HF	2050 Hz	2050 Hz	1800 Hz	1800 Hz
Slope MF-HF	24 dB/Octave	24 dB/Octave	24 dB/Octave	24 dB/Octave
Housing	Multiplex	Multiplex	Multiplex	Multiplex
Angles Up	Monitor use 40°	Monitor use 40°	Monitor use 45°	Monitor use 45°
Handles	1x top side, recessed	1x top side	3 (1x top side, 1x side)	3 (1x top side, 1x side)
Rigging points	10 x M8	12 x M8	12 x M10	12 x M10
Pole mount	D36 mm	D36 mm	D36 mm	D36 mm
Width	260 mm (10.24 in)	300 mm (11.8 in)	360 mm (14.17 in)	430 mm (16.93 in)
Height	420 mm (16.54 in)	480 mm (18.9 in)	610 mm (24 in)	680 mm (26.77 in)
Depth	260 mm (10.24 in)	300 mm (11.8 in)	360 mm (14.17 in)	430 mm (16.93 in)
Weight	10.1 kg (22.27 lbs)	13.5 kg (29.76 lbs)	17 kg (37.5 lbs)	20.7 kg (45.64 lbs)

Σ SIGMA Series

SIGMA **S115**
SIGMA **S115F**
SIGMA **S215**
SIGMA **S118**
SIGMA **S218**

Digital Active Speakers & Subs

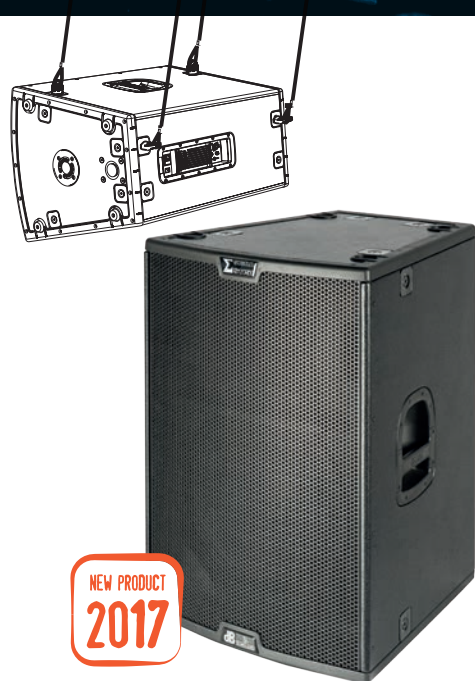

SIGMA **S115/F**

2-Way Active Speaker 15"/1.4", 1000 W

This active 15"/1.4" two-way system is musicians and DJs' first choice in a full-range FOH speaker. The S115's reach is remarkable thanks to its assertive midrange, prominent top end, and constant directivity at high sound pressure levels. SIGMA S115F is a flyable version of the same system, featuring 16 pickpoints for MA 10x35 eyebolts on top, bottom, rear and both lateral sides of the speaker.

SIGMA **S115/F**

SIGMA **S215**

Speaker Type	2-Way Active Speaker	Quasi 3-Way Active Speaker
Frequency Response [-10dB]	54 - 19.600 Hz	45 - 20.000 Hz
Max SPL	135 dB	137 dB
HF	1.4", 2.84" v.c.	1.4", 2.84" v.c.
Type HF	Compression driver	Compression driver
Directivity	60 x 40°	60 x 40°
Horn	Rotatable CD horn	Rotatable CD horn
LF	15", 3" v.c.	2x 15" (1 *with phase plug), 3" v.c.
Amp Technology	Digipro® G2	Digipro® G2
Amp Class	Class-D	Class-D
PRG Power	1000 W	1400 W
Controller	DSP 56 bit	DSP 56 bit
AD/DA Converter	24bit/48kHz	24bit/48kHz
System Presets	Flat, Boost	Flat, Boost
Limiter	Dual Active Peak, RMS, Thermal	Dual Active Peak, RMS, Thermal
Crossover Frequency	1100 Hz - 24 dB/Octave	1100 Hz - 24 dB/Octave
Signal Input	XLR	XLR
Signal Output	XLR Link Out	XLR Link Out
Housing	Plywood	Plywood
Handles	2 (1x side)	4 (2x side)
Rigging points	16 (only SIGMA S115F)	
Pole mount	D36mm on bottom	
Width	509 mm (20.04 in)	509 mm (20.04 in)
Height	765 mm (30.19 in)	1215 mm (47.83 in)
Depth	533 mm (20.98 in)	533 mm (20.98 in)
Weight	33 kg (72.75 lbs)	50 kg (110.23 lbs)

Digital Active Speakers & Sub

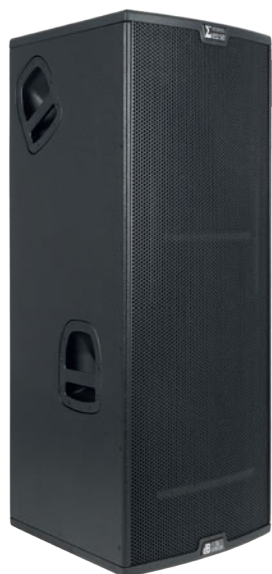

SIGMA S215

Quasi 3-Way Active Speaker 2 x 15"/1.4", 1400 W

Many venues demand high SPL and low-ranging response. However, a full-range enclosure is often the only viable option for some of these applications. Loaded with two 15" woofers designed to handle considerable loads, the S215 is the solution of choice for such scenarios.

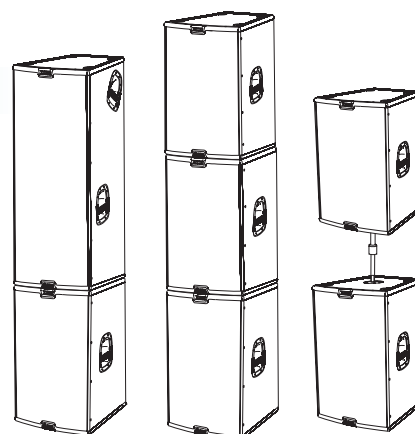

SIGMA S118

Active Subwoofer 18", 1400 W

The S118 is a powerful, active 18" subwoofer housed in a bassreflex enclosure. Designed specifically to provide low-frequency support for highperformance S115 full-range speakers, it packs a mighty low-ranging bass punch. S118 and S115 enclosures have the same width so they are easily stacked to set up professional-grade PA systems.

Engineered for portability

Musicians and DJs who provide their own backline need a reliable sound system that sets up in a flash and is easily tweaked without a lot of fuss. It has to respond directly and predictably to every mix.

Live gigs need resilient speakers with lots of load handling and saying power in order to operate at high levels for hours on end. The rig has to deliver tight, punchy bass response that gets people dancing as well as assertive mids and a sparkling top end. And it has to be easy to handle. The SIGMA line does all this and more.



SIGMA S218

Active Subwoofer 2x 18", 2700 W

The new SIGMA S218 is an active bass reflex subwoofer that comes as the perfect matching for SIGMA S115 F, ensuring the best behaviour as a full-range cluster both for live and installed applications.

It is equipped with two 18" woofers (4" voice coil) and a CLASS D Digipro G3 2700 W PRG Power. The double input and output allows a mono or stereo configuration. On-board Phase and Delay controls allows to precisely configure the system in every situation to make the most of a powerful yet precise PA system.

SIGMA S118 SIGMA S218

Speaker Type	Active Bassreflex Subwoofer	Active Bassreflex Subwoofer
Frequency Response [- 10dB]	38 - 110 Hz	42 - 120 Hz
Max SPL	134 dB	138 dB
LF	18", 4" v.c.	2x 18", 4" v.c.
Amp Technology	Digipro® G2	Digipro® G3
Amp Class	Class-D	Class-D
PRG Power	1400 W	2700 W
Controller	DSP 56 bit	DSP 56 bit
AD/DA Converter	24bit/48kHz	24bit/48kHz
Limiter	Peak, RMS, Thermal	Peak, RMS, Thermal
Crossover Frequency	80-100 Hz (Switchable)	90-120 Hz (Switchable)
Signal Input	XLR	2x XLR
Signal Output	1x XLR X-Over Out/ Link Out	2x XLR X-Over Out/ Link Out
Housing	Plywood	Plywood
Handles	2 (1x side)	4 (2x side)
Pole mount	M20 on top	M20 on top
Width	509 mm (20.04 in)	509 mm (20.04 in)
Height	815 mm (32.09 in)	1215 mm (47.83 in)
Depth	533 mm (20.98 in)	533 mm (20.98 in)
Weight	38 kg (83.78 lbs)	59.8 kg (131.84 lbs)

FLEXSYS **F212**
FLEXSYS **F315**
FLEXSYS **FM8**
FLEXSYS **FM10**
FLEXSYS **FM12**

Digital Active Speakers & Monitors



Flexibility and ease of use

When greater SPL and low-ranging response are needed, the right solutions are FLEXSYS F212 and F315. The first model is characterized by a pair of 12" woofers (driven by the same amp channel) with a phase-plug in front of the upper one, which avoids the overlapping of vertical phases that normally occur in this type of configuration and ensures a correct horizontal coverage of the medium frequencies. Furthermore, the trapezoidal-shaped housing (20° angle) allows the side-by-side setup of several speakers in cluster configuration. The FLEXSYS F315 is, however, a 3-way acoustic design (2-way electrically) with a 15" woofer a 6" midrange and a 1" compression driver. The result is a speaker particularly suitable to FOH purposes.

FLEXSYS F212

FLEXSYS F315

Speaker Type	Quasi 3-Way Active Speaker	3-Way Bi-Amp Active Speaker
Frequency Response [- 10dB]	55 - 20.000 Hz	47 - 20.000 Hz
Frequency Response [- 3dB]	65 - 19.000 Hz	60 - 19.000 Hz
Max SPL	132 dB	131 dB
HF	1"	1"
Type HF	Neodymium compression driver	Neodymium compression driver
Directivity	60° x 40°	90° x 40°
Horn	Rotatable CD Horn	CD horn
MF		6.5", 2.5" voice coil, hornloaded
LF	2x12" (with phase plug)	15"
Amp Technology	Digipro [®]	Digipro [®]
Amp Class	Class-D	Class-D
RMS Power	1000 W	1000 W
Peak Power	2000 W	2000 W
Controller	DSP 56 bit	DSP 56 bit
AD/DA Converter	24bit/48kHz	24bit/48kHz
System Presets	Flat, Clustered	Flat, Processed
Limiter	Dual Active Peak, RMS, Thermal	Dual Active Peak, RMS, Thermal
Crossover Frequency	LF-HF: 1800 Hz	LF-MF: 750 Hz; MF-HF: 2000 Hz
Slope MF-HF	24dB/oct	24dB/oct; 18dB/oct
Housing	Multiplex	Multiplex
Width	360 mm (14.17 in)	440 mm (17.32 in)
Height	930 mm (36.61 in)	880 mm (34.65 in)
Depth	500 mm (19.68 in)	500 mm (19.68 in)
Weight	31.5 kg (69.45 lbs)	31 kg (68.34 lbs)

Digital Active Speakers & Monitors

Active Coaxial Stage Monitors

A revolution in live sound reinforcement, the Flexsys FM Series comprises a range of tailored monitoring solutions featuring innovative technologies.

Housed in compact multifunctional enclosures, these units raise the bar for intelligibility, definition, and ease of use. They are the discerning user's first choice when nothing less than the best on-stage monitoring will do.



Remarkably resistant to feedback

These newly developed coaxial speakers deliver extraordinary sound quality that defies the compact design of their housings.

Engineered for precise directivity and uniform throw patterns, they provide the same satisfying audio experience at every listening position, with far greater resistance to feedback.

DSP with eight presets for easy adaptation to varying requirements

FM Series monitors feature a powerful DSP that offers a crossover, digital multiband limiters, phase correction, and eight variable presets to adapt the monitor to the varying demands of vocalists, instrumentalists, and audio playback applications.



FLEXSYS **FM8** FLEXSYS **FM10** FLEXSYS **FM12**

2-Way Active Coaxial Stage Monitor	2-Way Active Coaxial Stage Monitor	2-Way Active Coaxial Stage Monitor	Speaker Type
85 - 20.000 Hz	78 - 20.000 Hz	70 - 20.000 Hz	Frequency Response [- 3dB]
117 dB	120 dB	126 dB	Max SPL
1"	1"	1"	HF
1"	1"	1.3"	HF voice coil
Compression driver	Compression driver	Compression driver	Type HF
60° x 60°	60° x 90°	60° x 90°	Directivity
CD horn	CD horn	CD horn	Horn
8" coaxial	10" coaxial	12" coaxial	LF
2"	2"	2"	LF voice coil
Digipack®	Digipack®	Digipack®	Amp Technology
Class-D	Class-D	Class-D	Amp Class
200 W	400 W	600 W	PRG Power
400 W	800 W	1200 W	Peak Power
DSP 56 Bit	DSP 56 Bit	DSP 56 Bit	Controller
24bit/48kHz	24bit/48kHz	24bit/48kHz	AD/DA Converter
8 presets	8 presets	8 presets	System Presets
Dual Active Peak, RMS, Thermal	Dual Active Peak, RMS, Thermal	Dual Active Peak, RMS, Thermal	Limiter
LF-HF: 1950 Hz	LF-HF: 1950 Hz	LF-HF: 1850 Hz	Crossover Frequency
24dB/oct	24dB/oct	24dB/oct	Slope MF-HF
Multiplex with H.E.T coating, reinforced	Multiplex with H.E.T coating, reinforced	Multiplex with H.E.T coating, reinforced	Housing
Multifunctional, Low Profile	Multifunctional, Low Profile	Multifunctional, Low Profile	Housing Design
2 monitor angles	2 monitor angles	2 monitor angles	Angles Up
280 mm (11.02 in)	370 mm (14.57 in)	450 mm (17.72 in)	Width
290 mm (11.42 in)	290 mm (11.42 in)	290 mm (11.42 in)	Height
410 mm (16.14 in)	410 mm (16.14 in)	410 mm (16.14 in)	Depth
9.8 kg (21.61 lbs)	12.8 kg (28.22 lbs)	17 kg (37.48 lbs)	Weight

OPERA

Series

OPERA 10
OPERA 12
OPERA 15

1200 W PEAK POWER

NEWLY DESIGNED ASYMMETRICAL HORN

ADVANCED DSP WITH FIR PROCESSING

2 INPUT CHANNELS (MIC-LINE/MIC-INSTR)

SELECTABLE OUTPUT CHANNEL (LINK CH1/MIX CH 1+2)

8 EQ PRESETS

Professional Active Speakers



Being for many years dBTechnologies' flagship, the celebrated Opera series left a powerful footprint in sound reinforcement history. Now dBTechnologies makes the history evolve, getting back to basics with these three brand new 10", 12" and 15" professional powered speakers.

Exceptional power and a unique acoustic design combined in order to deliver a vigorous yet pristine sound, successfully adaptable to both playback and live music applications. With new OPERA series, dBTechnologies succeeded once again in packing leading edge DSP processing, advanced design features and user friendliness in an unrivalled cabinet in its price range.

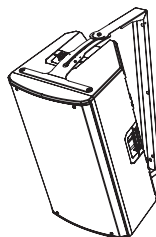

Unrivalled power and design at the service of performers

Opera's asymmetrical horn, which dramatically contributed to the success of the series, has been completely redesigned in order to obtain both an asymmetrical vertical dispersion and a double horizontal dispersion, ensuring an optimized throw pattern.

All 3 models of the series are equipped with a powerful Class D 600 W amplifier featuring advanced DSP processing where FIR filters allow the systems to deliver a coherent audio performance, uniform and crystal-clear from every listening position, thanks to an extremely flat phase response.



Professional Active Speakers



A stellar audio performance sets the stage for success

All models features 2 input channels (allowing live performers to use the system both for vocals and instruments or vocals and playback music), 2 selectable output channels (LINK CH 1 or MIX CH 1+2) and 8 preset equalizations which adapts to the most different environments, making OPERA the perfect companion for the discerning performer.

The new functional yet polished design features a full grille, a top and a side handle easing monitoring purposes. The cabinet comes with an integrated pole mount cup allowing stacked configurations with dBTechnologies bass bins.



	OPERA 10	OPERA 12	OPERA 15
Speaker Type	2-Way Active Speaker	2-Way Active Speaker	2-Way Active Speaker
Frequency Response [- 10dB]	58 - 20.000 Hz	52 - 20.000 Hz	50 - 20.000 Hz
Frequency Response [- 3dB]	70 - 19.600 Hz	67 - 19.600 Hz	46 - 19.600 Hz
Max SPL	128 dB	129 dB	130 dB
HF	1" Exit, 1.4" v.c.	1" Exit, 1.4" v.c.	1" Exit, 1.4" v.c.
Type HF	Compression driver	Compression driver	Compression driver
Horizontal Directivity	110° (85° up / 120° down)	110° (85° up / 120° down)	110° (85° up / 120° down)
Vertical Directivity	85° (+25° / -60°)	85° (+25° / -60°)	85° (+25° / -60°)
Horn	Asymmetrical Horn	Asymmetrical Horn	Asymmetrical Horn
LF	10", 2" v.c.	12", 2" v.c.	15", 2" v.c.
Amp Technology	Amp SMPS Power supply dual range	Amp SMPS Power supply dual range	Amp SMPS Power supply dual range
Amp Class	Class-D	Class-D	Class-D
RMS Power	600 W	600 W	600 W
Peak Power	1200 W	1200 W	1200 W
Controller	DSP 56 bit	DSP 56 bit	DSP 56 bit
AD/DA Converter	24 bit / 48 kHz	24 bit / 48 kHz	24 bit / 48 kHz
System Presets	Rotary Encoder (8 presets)	Rotary Encoder (8 presets)	Rotary Encoder (8 presets)
Crossover Frequency	1800 Hz	1800 Hz	1800 Hz
Limiter	Peak, RMS, Thermal	Peak, RMS, Thermal	Peak, RMS, Thermal
Advanced DSP Function	Linear Phase FIR filters	Linear Phase FIR filters	Linear Phase FIR filters
Signal Input	1x Combo (XLR-Jack 6.3 mm) MIC/Line 1x Combo (XLR-Jack 6.3 mm) MIC/Inst	1x Combo (XLR-Jack 6.3 mm) MIC/Line 1x Combo (XLR-Jack 6.3 mm) MIC/Inst	1x Combo (XLR-Jack 6.3 mm) MIC/Line 1x Combo (XLR-Jack 6.3 mm) MIC/Inst
Signal Output	1x XLR Male (Ch1 Link/Mix OUT) Selectable	1x XLR Male (Ch1 Link/Mix OUT) Selectable	1x XLR Male (Ch1 Link/Mix OUT) Selectable
Housing	Polypropylene	Polypropylene with Internal Frame	Polypropylene with Internal Frame
Grille	Full grille	Full grille	Full grille
Handles	1x Side, 1x Top	1x Side, 1x Top	1x Side, 1x Top
Rigging Points	2x M10 on Top + 1x M10 on Back	2x M10 on Top + 1x M10 on Back	2x M10 on Top + 1x M10 on Back
Pole Mount	D36 mm	D36 mm	D36 mm
Angles Up	Monitor use 45°	Monitor use 45°	Monitor use 45°
Width	300 mm (11.81 in)	350 mm (13.78 in)	420 mm (16.54 in)
Height	552 mm (21.73 in)	642 mm (25.28 in)	722 mm (28.43 in)
Depth	301 mm (11.85 in)	349 mm (13.74 in)	419 mm (16.50 in)
Weight	12.3 kg (27.12 lbs.)	14.3 kg (31.53 lbs.)	18.3 kg (40.34 lbs.)

B·HYPE
Series

B-Hype **8**
B-Hype **10**
B-Hype **12**
B-Hype **15**

2-Way Active Speakers



MAXIMUM EFFICIENCY UP TO 126.5 dB SPL

INNOVATIVE HORN DESIGN FOR UNIFORM AND EXTENDED COVERAGE

COMPACT FEATHERWEIGHT

CLEAN AND CONTEMPORARY DESIGN ENHANCING PORTABILITY

3 HANDLES

DOUBLE STAGE MONITOR ANGLE

PRESET EQ FLAT /BOOST



2-Way Active Speakers



Maximum amp efficiency for an assertive SPL

B-Hype series aims to provide a professional sonic performance to all kind of users, combining an extremely efficient CLASS D amplifier with aggressive sound pressure levels while delivering the most accurate sound reproduction.

Faithful and loud

The internal acoustic design features an innovative asymmetrical horn ensuring a uniform throw pattern. What's more, dBTechnologies team crafted an accurate digital sound processing, allowing users to choose between 2 preset EQ: FLAT or BOOST. This way, all B-Hype models deliver the most faithful sound performance while boosting any background music.

Sharp design and enhanced portability

B-Hype's featherweight cabinets (from 14 to 38 lbs) come with a clean and contemporary full grille design, enhancing both portability (3 handles, 1x side and 1 on top) and multifunctionality.

Each cabinet can be used

horizontally as a stage monitor (on both sides) and features a pole mount cup in order to be used on tripods or stacked on dBTechnologies Subs.



B·HYPE 8 B·HYPE 10 B·HYPE 12 B·HYPE 15

Speaker Type	2-Way Active Speaker	2-Way Active Speaker	2-Way Active Speaker	2-Way Active Speaker
Frequency Response [- 10dB]	65 - 20.000 Hz	55 - 20.000 Hz	55 - 20.000 Hz	51 - 20.000 Hz
Frequency Response [- 6dB]	70 - 19.600 Hz	62 - 19.600 Hz	61 - 19.500 Hz	57 - 19.700 Hz
Max SPL	120 dB	121 dB	126 dB	126.5 dB
HF	1" CD, 1" v.c.	1" CD, 1" v.c.	1" CD, 1" Neod. v.c.	1" CD, 1" Neod. v.c.
LF	8", 1.5" v.c.	10", 1.5" v.c.	12", 2" v.c.	15", 2" v.c.
Horizontal Dispersion	asymmetrical 85° up / 120° down	asymmetrical 85° up / 120° down	asymmetrical 85° up / 120° down	asymmetrical 85° up / 120° down
Vertical Dispersion	85° (+25°/-60°)	85° (+25°/-60°)	85° (+25°/-60°)	85° (+25°/-60°)
Crossover Frequency	2300 Hz (24 dB/oct.)	2300 Hz (24 dB/oct.)	2100 Hz (24 dB/oct.)	2100 Hz (24 dB/oct.)
Amp Technology	Class-D	Class-D	Class-D	Class-D
Peak Power	260 Watt	260 Watt	400 Watt	400 Watt
Controller	DSP 56 bit	DSP 56 bit	DSP 56 bit	DSP 56 bit
AD/DA Converter	24 bit / 48 kHz	24 bit / 48 kHz	24 bit / 48 kHz	24 bit / 48 kHz
System Presets	Flat, Processed	Flat, Processed	Flat, Processed	Flat, Processed
Limiter	Peak, RMS, Thermal	Peak, RMS, Thermal	Peak, RMS, Thermal	Peak, RMS, Thermal
Housing	Polypropylene PP	Polypropylene PP	Polypropylene PP	Polypropylene PP
Handles	3 (2 on sides, 1 on top)	3 (2 on sides, 1 on top)	3 (2 on sides, 1 on top)	3 (2 on sides, 1 on top)
Angles Up	Monitor use 45°	Monitor use 45°	Monitor use 45°	Monitor use 45°
Pole Mount	Ø36 mm	Ø36 mm	Ø36 mm	Ø36 mm
Width	243 mm (9.57 in)	295 mm (11.61 in)	350 mm (13.77 in)	415 mm (16.34 in)
Height	443 mm (17.44 in)	544 mm (21.42 in)	645 mm (25.40 in)	725 mm (28.54 in)
Depth	231 mm (9.09 in)	283 mm (11.14 in)	330 mm (12.99 in)	391 mm (15.39 in)
Weight	6.6 kg (14.55 lbs.)	9 kg (19.84 lbs.)	13.9 kg (30.46 lbs.)	17.4 kg (38.36 lbs.)

SUB

Series

SUB 15H
SUB 18H
SUB 615
SUB 618
SUB 28D
SUB 12D

Active Subwoofers

dBTechnologies presents a complete family of active subwoofers (Sub H, Sub 600 and SUB D series) suitable for mid-sized to small venues. Compact systems conveying a deep, enveloping sound and excellent low-end performances even at a close listening distance.

SUB 15H & SUB 18H

dBTechnologies new H Series subwoofers offer remarkable specifications and user-friendliness.

With 1000W PRG (1400W Peak Power) and a high-performance 15" woofer with 3" coil, the Sub 15H is especially suited for small to mid-sized events, where high performance needs to be packaged into compact size.

Whenever a lower extension is required, the perfect choice is the new Sub 18H, equipped with a 1500W PRG (2000W Peak Power) power amplifier and a high-performance 18" woofer with 4" coil.



Thanks to their unique configuration, called **Hybrid Horn-Loading**, boxes can be tuned to the lowest frequencies to improve system efficiency and convey a deep, enveloping sound.

Unlike conventional horn loaded systems, 15H and 18H subs ensure excellent efficiency even at close listening distance, which makes them suited for use even in small venues.

The new 15H sub offers stereo inputs with selectable link or crossover outputs, a crossover frequency switch at 90 or 120 Hz, a phase inversion switch and **built-in delay up to 4.5 ms** (adjustable in 0.5 ms steps).

The delay helps you to improve the correct coupling with the whole line-up of dBTechnologies full-range speakers, and make advanced subwoofer configurations without the help of any external processor (**Cardioid** or **End-Fire** or **Straight Line**).

The subs also feature a mini USB port to update system firmware and retrieve a telemetry log file that provides information on abnormal events, usage time and amplifier status.

Active Subwoofers



The latest-generation digital amplifier Digipro™ G3 ensures excellent performance and low energy consumption thanks to its highly efficient, yet very lightweight system. The auto-range digital power supply allows it to operate both on 110V~ and on 220V~.

The new 56 Bit DSP with 24 Bit/48KHz A/D conv. provides sound performance above all expectations and perfect system control even under the most extreme operating conditions, thanks to its advanced limiting functions.

The PVC faced birch plywood speaker box is extra resistant also thanks to polypropylene edges that protect it from scratching or impacts during transport. This unique Hybrid Enclosure Technology offers outstanding strength and durability, making

your speaker truly road-ready, with their exclusives Aluminum heavy-duty handles.

The M20 threaded mount on the top end of the box permits any type of full-range speaker to be installed using a standard pole with M20 thread.

DS2-S mini pole is also available as an option to adapt any dBTechnologies speaker to 15H and 18H subs.



SUB 15H

SUB 18H

Speaker Type	Semi Horn-loaded Active Subwoofer	Semi Horn-loaded Active Subwoofer
Frequency Response [- 10dB]	35 - 150 Hz	28 - 150 Hz
Max SPL	133 dB	134 dB
LF	15"	18"
LF voice coil	3"	4"
Amp Technology	Digipro G3®	Digipro G3®
Amp Class	Class-D	Class-D
PRG Power	1000 W	1500 W
Peak Power	1400 W	2000 W
Power supply	700 W SMPS with PSU Auto-range (110V~ and 220V~)	1000 W SMPS with PSU Auto-range (110V~ and 220V~)
Controller	DSP 56 bit	DSP 56 bit
AD/DA Converters	24 bit/48 kHz	24 bit/48 kHz
Limiter	Dual Active, Multiband, RMS/Peak, Thermal	Dual Active, Multiband, RMS/Peak, Thermal
Crossover Frequency	90 or 120 Hz, 24dB/Octave	90 or 120 Hz, 24dB/Octave
Controls	X-Over frequency selection, Delay (up to 4.5 ms), Phase inversion switch	X-Over frequency selection, Delay (up to 4.5 ms), Phase inversion switch
Signal Input	2x XLR	2x XLR
Signal Output	2x XLR X-Over Out/Link Out	2x XLR X-Over Out/Link Out
Housing	Birch plywood, Black PVC cover	Birch plywood, Black PVC cover
Handles	2 (1x side)	2 (1x side)
Pole mount	M20 (aluminium)	M20 (aluminium)
Width	524 mm (20.63 in)	524 mm (20.63 in)
Height	511 mm (20.12 in)	711 mm (27.99 in)
Depth	695 mm (27.36 in)	695 mm (27.36 in)
Weight	31.5 kg (69.45 lbs.)	41.4 kg (91.27 lbs.)

1200 W PEAK CLASS D AMP

STEREO OR MONO BALANCED INPUT

LINK OR X-OVER BALANCED STEREO OUTPUT MODE

COMPACT AND STURDY WOOD CABINET

LIGHTWEIGHT

POLARITY SWITCH

FLAT OR BOOST MODE SWITCH

Low end precision

SUB 600 series has been designed to create complete PA systems making the most of dBTechnologies portable full range systems.

Able to deliver outstanding sound pressure levels in spite of their compact housing, SUB 600s provide a clean, impressively precise low-end reproduction. Both models features a 600W RMS Class D Power Amplifier with SMPS and are equipped with respectively 15" or 18" premium transducers.

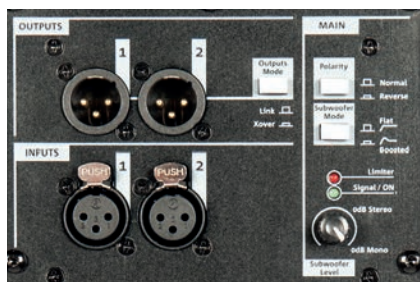

Sub 600s' remarkable audio performance allows users to build most of the PA systems with 1 single sub and 2 full range speakers, avoiding any external processing or crossover thanks to a balanced Xover signal to left and right speakers. Controls on the amp panel allow user to operate with Mono or Stereo audio feed, activate polarity inversion and choose Outputs link mode (True Bypass or Xover). Whenever a further punch is needed, a low-frequencies boost EQ can be set thanks to the Sub Mode switch.

The series comes with a full grille design in a lightweight wood cabinet strengthened with a hardwearing, scratch-resistant black covering. Carved side handles enhance portability. The design of the top side eases subs stacking in larger systems and features a M20 pole mount thread to stack full-range speakers.



SUB 615

SUB 618

Speaker Type	Active Bass-reflex Subwoofer	Active Bass-reflex Subwoofer
Frequency Response [- 10dB]	42 - 124 Hz	35 - 130 Hz
Max SPL (1m)	131 dB	133 dB
Directivity	Omnidirectional	Omnidirectional
LF	15"	18"
LF voice coil	2.5"	2.5"
Amp Technology	SMPS digital amplifier	SMPS digital amplifier
Amp Class	Class-D	Class-D
Peak Power	1200 W	1200 W
Controller	DSP 24 bit/48 kHz	DSP 24 bit/48 kHz
Limiters	Peak, Thermal, RMS	Peak, Thermal, RMS
Crossover Frequency	90 Hz, 24dB/Octave	90 Hz, 24dB/Octave
Controls	Subwoofer level, Outputs mode, Polarity, Subwoofer mode	Subwoofer level, Outputs mode, Polarity, Subwoofer mode
Signal Input	2x XLR	2x XLR
Signal Output	2x XLR X-Over Out/Link Out	2x XLR X-Over Out/Link Out
Housing	Plywood	Plywood
Handles	2 (1x side)	2 (1x side)
Pole mount	D36 mm on top	D36 mm on top
Width	430 mm (16.92 in)	500 mm (19.69 in)
Height	580 mm (22.83 in)	625 mm (24.60 in)
Depth	600 mm (23.62 in)	690 mm (27.17 in)
Weight	25.5 kg (56.22 lbs)	31.1 kg (68.57 lbs)

Active Subwoofers

SUB 28D

Active 2x8" Subwoofer

We engineered the SUB 28 D to provide low-end reinforcement for compact satellites such as dBTechnologies L and K Series speakers.

This light and lean enclosure houses two 8" woofers driven by a 800W digital power amp and an on-board digital stereo x-over. Setting up mono and stereo satellite systems is a piece of cake with this amp and DSP on board.



SUB 12D

Active 12" Subwoofer

Equipped with a 800W digital power amp, the SUB 12 D is the perfect complement to 8" or 10" speaker systems for users looking to set up small but assertive satellite systems that deliver exceptional performance.

Featuring compact dimensions and the innovative H.E.T™ housing, this unit is easy to transport and set up. Connecting satellites is an exercise in convenience thanks to an integrated digital crossover (DSP) with adjustable frequency.



SUB 28D

SUB 12D

Speaker Type	Active Bandpass Subwoofer	Active Bandpass Subwoofer
Frequency Response [- 10dB]	45 - 150 Hz	40 - 150 Hz
Max SPL	125 dB	127 dB
Directivity	Omnidirectional	Omnidirectional
LF	2x 8"	12"
LF voice coil	1.5"	2.5"
Amp Technology	Digipack™	Digipack™
Amp Class	Class-D	Class-D
Peak Power	800 W	800 W
Controller	DSP 24 bit/48 kHz	DSP 24 bit/48 kHz
Phase	0, 180°	0, 180°
Limiter	Dual Active Limiter	Dual Active Limiter
Crossover Frequency	110 Hz, 24dB/Octave	90 Hz, 24dB/Octave
System Presets	Flat, Boost	Flat, Boost
Signal Input	2x XLR	2x XLR
Signal Output	2x XLR X-Over Out/Link Out	2x XLR X-Over Out/Link Out
Housing	Multiplex with H.E.T coating, reinforced	Multiplex with H.E.T coating, reinforced
Handles	2 (1x side)	2 (1x side)
Pole mount	D36 mm on top	D36 mm on top
Width	290 mm (11.42 in)	390 mm (15.35 in)
Height	520 mm (20.47 in)	520 mm (20.47 in)
Depth	505 mm (19.88 in)	505 mm (19.88 in)
Weight	19.5 kg (42.99 lbs)	24 kg (52.91 lbs)



MINIBOX Series

MINIBOX L80D
MINIBOX L160D
MINIBOX K300
MINIBOX K162
MINIBOX K70

Compact Active Speakers

MINIBOX L SERIES

L80D: Mini Box, Great Talent

MINIBOX L80D collects the technological heritage of the renowned MINIBOX L160D in a smaller and handy format. It is the ideal answer to all those musical and multimedia applications where a very compact, powerful and high-performance speaker is needed. Two 4" phase-corrected woofers, one equipped with a coaxial 1" dome tweeter, deliver astonishingly high sound pressure levels for their size and an amazingly transparent and articulate sonic image.

Technically evolved

The 80W Class-D Digipro® power amp with proven reliability and efficiency packs huge performance and operating efficiency into a lightweight solution that takes a very small footprint. The MINIBOX L80D features a powerful 56bit DSP with 24bit/48kHz AD/DA conversion, which allows the user to choose directly from the box the most adequate equalization for the desired use, by optimizing the performance without the need of external processors.



MINIBOX
L80D



MINIBOX
L160D

Speaker Type	2-Way Active Speaker	2-Way Active Speaker
Freq. Response [- 10dB]	90 - 20.000 Hz	70 - 20.000 Hz
Max SPL	112 dB	116 dB
HF	1"	1"
Type HF	Dome tweeter, coaxial	Dome tweeter, coaxial
Directivity	85° x 75°	85° x 75°
LF	2x4"	2x5"
Amp Technology	Digipro®	Digipro®
Amp Class	Class-D	Class-D
PRG Power	80 W	160 W
Cooling	Convection	Convection
Controller	DSP 56 bit	DSP 56 bit
AD/DA Converter	24bit/48kHz	24bit/48kHz
System Presets	8	8
Limiter	Dual Active Peak, RMS, Thermal	Dual Active Peak, RMS, Thermal
Signal Input	1x XLR Line In/Mic 1x 6.3mm phone jack 1x RCA cinch AUX with volume ctrl	1x XLR Line In/Mic 1x 6.3mm phone jack 1x RCA cinch AUX with volume ctrl
Microphone Input	Yes	Yes
Signal Output	1x 6.3mm phone jack	1x 6.3mm phone jack
Power Socket	VDE	VDE
Voltage Range	110-120 - 220-240 V	110-120 - 220-240 V
Housing	Polypropylene PP	Polypropylene PP
Angles Up	Monitor use 60°	Monitor use 60°
Rigging Points	2x M5 on side 2x M5 on bottom	2x M5 on side 2x M5 on bottom
Width	155 mm (6.10 in)	200 mm (7.87 in)
Height	265 mm (10.43 in)	335 mm (13.19 in)
Depth	180 mm (7.09 in)	220 mm (8.66 in)
Weight	3.75 kg (8.27 lbs.)	5.2 kg (11.46 lbs.)



Compact Active Speakers



MINIBOX K SERIES

Active Speakers

The most powerful compact cabinet in its class, the K300 is chock-full of innovative technologies.

Housed in an ultra compact enclosure, its digipro® bi-amped digital power amp delivers high performance and sound pressure levels. The 1" HF driver renders midrange frequencies with pinpoint precision, and its response is richly detailed.

The integrated DSP further enhances clarity and accuracy, and protects components using digital limiters.



MINIBOX K70 MINIBOX K162 MINIBOX K300

Speaker Type	2-Way Active Speaker	2-Way Active Speaker	2-Way Active Speaker
Freq. Response [- 10dB]	100 - 18.000 Hz	85 - 19.000 Hz	70 - 20.000 Hz
Max SPL	101 dB	110 dB	118 dB
HF	Tweeter	Tweeter	1" Neodymium driver
LF	5"	2x 6.5"	2x 6.5" Neo
Amp Class	Class-AB	Class-AB	Class-D, Digipro®
PRG Power	100 W	160 W	300 W
Cooling	Convection	Convection	Convection
Controller	Analog	Analog	DSP 24bit/48kHz
Limiter	Soft Clip	Soft Clip	Dual Active, Peak, RMS, Thermal
Signal Input	1x XLR 1x 6.3mm phone jack 1x RCA cinch	1x XLR 1x 6.3mm phone jack 1x RCA cinch	1x XLR 1x 6.3mm phone jack 1x RCA cinch
Microphone Input	Yes	Yes	Yes
Signal Output	1x XLR 1x 6.3mm phone jack 1x RCA cinch	1x XLR 1x 6.3mm phone jack 1x RCA cinch	1x XLR 1x 6.3mm phone jack 1x RCA cinch
Power Socket	VDE	VDE	VDE
Housing	Polypropylene PP	Polypropylene PP	Polypropylene PP
Pole Mount	Optional	Optional	Optional
Rigging Points	2x M5	4x M5	4x M5
Width	170 mm (6.69 in)	210 mm (8.27 in)	210 mm (8.27 in)
Height	270 mm (10.63 in)	350 mm (13.78 in)	350 mm (13.78 in)
Depth	185 mm (7.28 in)	270 mm (10.63 in)	270 mm (10.63 in)
Weight	3.5 kg (7.72 lbs.)	5.5 kg (12.12 lbs.)	5.5 kg (12.12 lbs.)

READY 4 Mk2

Battery-powered Bi-amp Speaker



SELF-POWERED SPEAKER

BACK PANEL FOR FAST ACCESS TO THE BATTERY

DIGITAL CLASS-D AMPLIFIER

**SMPS WITH AUTO-RANGE
(WORKS AT 110V~ OR 220V~)**

UHF 16 CH DIVERSITY RECEIVER BUILT-IN

XLR/JACK TRS/RCA INPUTS

USB PORT (FOR MP3 MEDIA PLAYERS)

BLUETOOTH® RECEIVER (OPTIONAL)

MIX OUTPUT

ULTRA-BRIGHT OLED SCREEN FOR USER INTERFACE



Battery-powered Bi-amp Speaker

Technology on the move

After the great success of the Mobile 110 sport speaker, dBTechnologies is introducing Ready 4, a high-performance and versatile speaker that will set a new standard for portable PA systems.



Featured with multiple power supply options (battery/power mains), the new Ready 4 can be used in any situation.

The battery ensures several hours of autonomy. An exhausted battery can be quickly replaced with a charged battery through the back removable panel. The speaker can be connected to 220 V or 110 V AC power, thanks to an SMPS with auto-range, or a 15 V power supply via an optional external adapter.

Based on the Black Line series box, the new Ready 4 features a stylish contemporary design that will suit any situation.

An optional **Bluetooth®** board, together with an integrated **UHF 16ch diversity receiver**, an **MP3 USB reader** and a stereo RCA input, enhances the excellent potential of the new Ready 4, placing it right at the top of its category. A **smart OLED day-viewable screen** can control all previous functions with an incredible ease of use.

A very wide choice of accessories are available for the Ready 4, ranging from an optional Bluetooth® stereo receiver module to lavalier, headset or handheld transmitter.



READY 4 Mk2 Accessories

BT-Ready 4	Bodypack transmitter
HM-Ready 4	Headset Microphone
HT-Ready 4	Handheld transmitter
PSU-R4	15 Vdc 3A power supply for READY 4
TC R4	Ready 4 Functional cover

READY 4 Mk2

Speaker Type	Bi-amp battery-powered speaker
Frequency Response [-10dB]	70 - 20.000 Hz
Max SPL	120 dB
HF	1", 1" v.c.
Directivity	80°/65° x 60°
Horn	Asymmetrical CD Horn
LF	10", 1.5" v.c.
Power Amp	Class-D Digipro G2® 200W Peak
Controller	DSP 56 bit
AD/DA converter	24bit/48kHz
DSP	6 presets EQ + User EQ Voice-Over function
Limiters	Dual active-Multiband RMS/Peak, Thermal
Special features	Digital battery charger, Battery management and power saving functions
User Interface	1x OLED Display with 4 keys for speaker management
Wireless Input	1x UHF diversity receiver, IR sync function
Mic/Line Input	XLR / 1/4" Jack Combo
Input Sens.	2-way switch (Mic - Line)
Stereo Media Aux Input	2x RCA
USB Media Reader	USB Type "A" port for media files (MP3-WMA-AAC)
Service USB	USB Type "B" input
Bluetooth® Input	1x Bluetooth® receiver
Mix Out	1/4" Jack (unbalanced)
Volume Controls	4x rotative knobs (Master, Mic/Line, Wireless, Media)
Indicators	2x LEDs (LIMITER, SIGNAL)
Mains	VDE Socket
	1x 3-position switch (External Power, Off, Internal Battery)
Housing	Polypropylene PP
Angles Up	Monitor use 43°
Handles	One on top
Pole Mount Plate	D36mm standard
Grille	1.2 mm metal with foam
Width	343 mm (13.72 in)
Height	553 mm (22.77 in)
Depth	304 mm (11.97 in)
Weight	11.3 kg (24.91 lbs.)

ARENA Series

ARENA 8
ARENA 10
ARENA 12
ARENA 15
ARENA SW15
ARENA SW18

Professional Passive Speakers & Subs



ARENA 8 ARENA 10 ARENA 12 ARENA 15

Speaker Type	2-Way Passive Speaker	2-Way Passive Speaker	2-Way Passive Speaker	2-Way Passive Speaker
RMS Power	200 W	300 W	400 W	400 W
Peak Power	400 W	600 W	800 W	800 W
Impedance	8 Ohms	8 Ohms	8 Ohms	8 Ohms
Frequency Response [-3dB]	100 - 19,000 Hz	95 - 19,000 Hz	80 - 19,000 Hz	80 - 19,000 Hz
Max SPL	122 dB	125 dB	127 dB	129 dB
HF	1"	1"	1"	1"
Driver Protection	PTC	PTC	PTC	PTC
Directivity	90x70°	90x70°	90x40°	90x40°
Horn	Rotatable CD horn	Rotatable CD horn	Rotatable CD horn	Rotatable CD horn
X-over Frequency (passive)	2100 Hz	2100 Hz	2000 Hz	2000 Hz
LF	8"	10"	12"	15"
Voice Coil LF	1.5"	2"	2"	2.5"
Signal Input	1x Speakon (Pin 1+=) (Pin 1=-)	11x Speakon (Pin 1+=) (Pin 1=-)	1x Speakon (Pin 1+=) (Pin 1=-)	1x Speakon (Pin 1+=) (Pin 1=-)
Signal Output	1x Speakon (Pin 1+=) (Pin 1=-)	1x Speakon (Pin 1+=) (Pin 1=-)	1x Speakon (Pin 1+=) (Pin 1=-)	1x Speakon (Pin 1+=) (Pin 1=-)
Housing	Multiplex birch plywood	Multiplex birch plywood	Multiplex birch plywood	Multiplex birch plywood
Pole mount	36mm	36mm	36mm	36mm
Angles Up	Monitor use 45°	Monitor use 45°	Monitor use 45°	Monitor use 45°
Rigging Points	12 x M8	10 x M8	12 x M10	12 x M10
Handles	1 on top	1 on rear	2 (1x side)	2 (1x side)
Width	270 mm (10.63 in)	321 mm (12.64 in)	379 mm (14.92 in)	458 mm (18.03 in)
Height	458 mm (18.03 in)	508 mm (20.00 in)	631 mm (24.84 in)	710 mm (27.95 in)
Depth	270 mm (10.63 in)	320 mm (12.60 in)	378 mm (14.88 in)	453 mm (17.83 in)
Weight	9.3 kg (20.50 lbs.)	12.2 kg (26.90 lbs.)	17.8 kg (39.24 lbs.)	23.7 kg (52.25 lbs.)

Professional Passive Speakers & Subs



The passive loudspeaker range ARENA offers high-quality 2-way enclosures and powerful subwoofers. This series can be used for many different mobile or fixed install applications due to its extensive configurations.

All high/mid units use a multipurpose housing made out of multilayer birch wood, offering a pole mount, 12 professional flypoints and a slanted backside for monitor applications.

Due to the premium loudspeaker components, all units are able to handle high sound pressure levels.

They offer outstanding, specially designed constant directivity horns which are rotatable by 90°, thanks to the symmetrical shape. The low weight of the enclosures allows easy handling.

All models are equipped with a black front grill with acoustic foam layer.

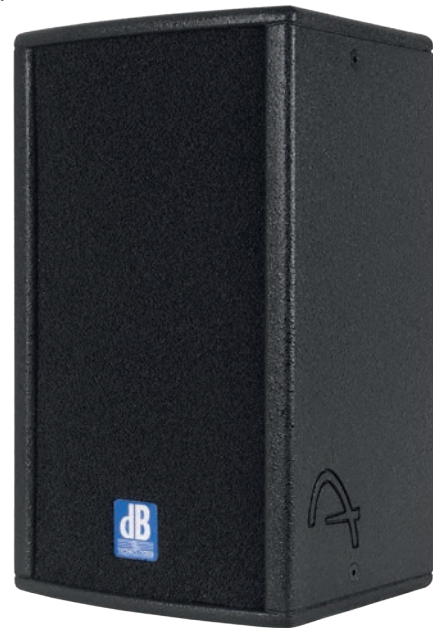

ARENA SW15

ARENA SW18

Passive Subwoofer	Passive Subwoofer	Speaker Type
500 W	600 W	RMS Power
1000 W	1200 W	Peak Power
8 Ohms	8 Ohms	Impedance
40 - 150 Hz	35 - 150 Hz	Frequency Response [- 3dB]
130 dB	132 dB	Max SPL
150 Hz	150 Hz	X-over Frequency (passive)
15"	18"	LF
3"	4"	Voice Coil LF
1x Speakon (Pin 1+=) (Pin 1=-)	1x Speakon (Pin 1+=) (Pin 1=-)	Signal Input
1x Speakon (Pin 1+=) (Pin 1=-)	1x Speakon (Pin 1+=) (Pin 1=-)	Signal Output
Multiplex birch plywood	Multiplex birch plywood	Housing
M20 on top	M20 on top	Pole mount
2 (1x side)	2 (1x side)	Handles
460 mm (18.11 in)	565 mm (22.24 in)	Width
600 mm (23.62 in)	700 mm (27.56 in)	Height
600 mm (23.62 in)	700 mm (27.56 in)	Depth
34 kg (74.96 lbs.)	44 kg (97.00 lbs.)	Weight

Passive 15" Subwoofer

The ARENA SW15 offers a 15" woofer with a 3" voice coil, which can take a load up to 500W/ RMS, putting out an extraordinary SPL of 130dB at very powerful low end frequencies.

It can be easily combined with ARENA10 and ARENA12 high/mid units, due to the internal passive crossover. Also possible is the bi-amp operation using an external crossover unit.

Passive 18" Subwoofer

The 4" voice coil of the ARENA SW18 delivers powerful and accurate low frequency reproduction, down to 35Hz, at a maximum load of 600W/RMS.

Sound pressure levels of up to 132dB at a crossover frequency of 150Hz using the internal crossover make this subwoofer the professionals choice.

This woofer can be easily combined with the ARENA satellite units, using just one external power amp.

OPERA P

PASSIVE SPEAKER



OPERA P15 is a passive speaker studied for sound reinforcement applications in small-to-medium venues. Despite its compact size, it delivers high sound pressure with a very flat frequency response.

The P15 is equipped with a 15" woofer (3" voice coil) and a 1" compression driver (1.75" voice coil), loaded with 80°/65°x60° asymmetric horn.

It is also equipped with an internal passive filter, to allow separate management of acoustic components by splitting the incoming audio signal into low and high frequencies. Crossover filters have a slope of 12dB/oct. for the low-pass and 18dB/oct. for the high-pass. High-frequency transducer is also protected from overloads through a self-resetting thermal protection circuit (PTC).

The speaker is made in reinforced polypropylene and the acoustic components are protected by 1.2mm metal grille with internal foam.

The polypropylene satisfies rigorous quality standards in the production of professional acoustic speakers. The use of this material makes it possible to obtain products with innovative design and suitable for various fields of application because of its strength and lightness.

OPERA P15

Speaker Type	2-Way Passive Speaker
Frequency Response [-10dB]	68 - 19,500 Hz
Max SPL	128 dB
RMS Power	400 W
Peak Power	800 W
Impedance	8 Ohms
HF	1" (1.75" v. c.)
Directivity	80°/65°x 60°
Horn	Asymmetrical Horn
Driver Protection	PTC
X-over Frequency (passive)	2100 Hz
LF	15"(3" v. c.)
Signal Input	2x Speakon
Housing	Polypropylene PP
Angles Up	Monitor use 43°
Handles	Two on sides, one on top
Pole Mount	D36 mm
Width	432 mm (17.01 in)
Height	655 mm (25.79 in)
Depth	353 mm (13.90 in)
Weight	18.4 kg (40.57 lbs.)

HPA Amplifiers



HPA 1000 HPA 1400 HPA 2800 HPA 3100

Power Output RMS (Stereo/Mono mode)				
2 ohms	-	-	2 x 1400W	2 x 1700W
4 ohms	2 x 510W	2 x 740W	2 x 1050W	2 x 1200W
8 ohms	2 x 330W	2 x 440W	2 x 680W	2 x 800W
Power Output RMS (Bridge mode)				
4 ohms	-	-	1 x 2800W	1 x 3400W
8 ohms	1 x 1020W	1 x 1480W	1 x 2100W	1 x 2400W
Amplifier Class	Class AB	Class H	Class H	Class HD
Distortion (THD+N)	<0,05% @ 1KHz and 1dB below clipping			
Signal To Noise ratio	105dB	105dB	106dB	108dB
Input impedance	20Kohm balanced/10Kohm unbalanced			
Protections	Temperature, DC, RFI, short circuit, Thermal power transformer			
Cooling	2 x variable speed fan			
Power supply	220-230Vac 50/60Hz		SMPS, 220-230Vac 50/60Hz	
Circuit breaker	T8A	T10A	T15A	T15A
Rear power supply socket	VDE -15A	VDE -15A	VDE -15A	VDE -15A
Width	483 mm (19.01 in)	483 mm (19.01 in)	483 mm (19,01 in)	484 mm (19.05 in)
Height	400 mm (15.75 in)	400 mm (15.75 in)	400 mm (15.75 in)	431 mm (16.97 in)
Depth	89 mm (3.50 in)	89 mm (3.50 in)	89 mm (3.50 in)	89 mm (3.50 in)
Rack height	2U			
Net weight	15.25Kg (33.62 lbs.)	17.25Kg (38.03 lbs.)	21.35Kg (47.07 lbs.)	14Kg (30.86 lbs.)

ELECTRONICS

AC26N

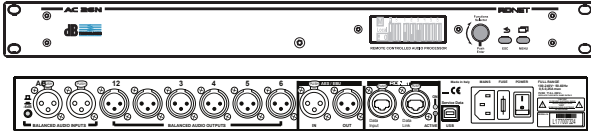

Description

Digital Audio Processor, 2 in - 6 out, Full Range power supply, RDNet Hardware Interface, USB interface, remotable via RDNet or USB. AES-EBU in/out. Max input level 21dBu (without pad) / 27dBu (with -6dB pad). Max output level 21dBu. DSP Processing: 28/56bit - 48Khz. A/D and D/A Converts: 24bit - 96Khz

ASX 24

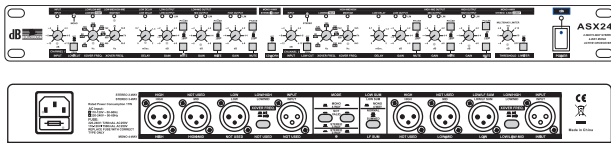

Description

2-Way/3-Way stereo - 4-Way Mono Active Crossover. 2x XLR-Input with 25Hz high-pass filter switch, 6x XLR-Output, high quality 24dB/octave slope Linkwitz-Riley filters, In/Out level controls, xover frequency selection for all bands, mute key and phase reversal for each band, adjustable delay time up to 2ms for outputs, "LOW SUM" function to convey the whole LF range of L&R channels to a mono sub out, multiband limiter with adjustable threshold

DSX 2040

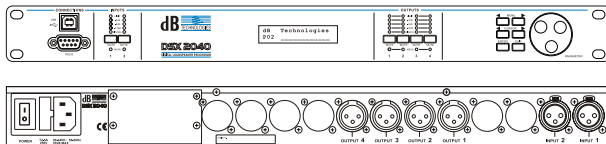

Description

Digital 2 in 4 controller, 48Khz/32-bit signal processing, dynamic range >110dB(A), 3000ms total delay, 4 parameters. EQs per in- and output, programmable x-over and routing-section, editable limiter per output, large LC-Display, bank for 30 presets, USB-interface for programming and data-transfer, 19", 1U, in- and outputs on balanced XLR

SWITCH 6

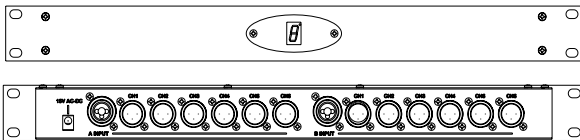

Description

2 x XLR-Input into 2x6 XLR-Output, 1 Unit with LED Display and Remote Control. Up to 6 units in parallel mode

ELECTRONICS FOR WIRELESS PRODUCTS

	Description	Designed for
PSU-R4	15 Vdc 3A power supply for READY 4	READY 4 Mk2
HT-READY 4	READY 4 handheld microphone with compatible ISM (863-865MHz) band radio transmitter	READY 4 Mk2
BT-READY 4	READY 4 compatible ISM (863-865MHz) band belt transmitter	READY 4 Mk2
HM-READY 4	Headset microphone for Ready 4	READY 4 Mk2
IC-B	Guitar cable for Moving One	MOVING ONE

Accessories

BAGS/COVERS

	Description	Designed for
FC-OP10	Functional cover for OPERA 10	OPERA 10
FC-OP12	Functional cover for OPERA 12	OPERA 12
FC-OP15	Functional cover for OPERA 15	OPERA 15
GBA 8	Bag for Arena 8	ARENA 8
GBA 10	Bag for Arena 10	ARENA 10
GBA 12	Bag for Arena 12	ARENA 12
GBA 15	Bag for Arena 15	ARENA 15
RC-M1	Magnetic Rain cover for INGENIA Series	IG1T / IG2T / IG3T / IG4T
RC MS12-SUBH	Rain cover for SUB 15H and 18H	SUB 15H / SUB 18H
TC-160D	Bag for two MINIBOX L160D	2x L160D
TC-28D	Bag for SUB 28D	SUB 28D
TC-BH8	Tour cover for B-Hype 8	B-Hype 8
TC-BH10	Tour cover for B-Hype 10	B-Hype 10
TC-BH12	Tour cover for B-Hype 12	B-Hype 12
TC-BH15	Tour cover for B-Hype 15	B-Hype 15
TC CR08	Tour cover for Cromo 8+	CROMO 8+
TC CR10	Tour cover for Cromo 10+	CROMO 10+
TC CR12	Tour cover for Cromo 12+	CROMO 12Club / CROMO 12+
TC-ES10	Tour cover for ES 602 subwoofer	ES 602 subwoofer
TC-ES12	Tour cover for ES 503 or ES 802 subwoofer	ES 503 or ES 802 subwoofer
TC-ES212	Tour cover for ES 1203 sub (included in ES 1203 system)	ES 1203 subwoofer
TC-ES44	Bag for 2 ES 1203 tops, D35mm pole and cable (included in ES 1203 system)	2x ES 1203 top
TC-ESTOP	Tour cover for 2 ES tops, D25mm pole and cable	2x ES 503 or 802 top or 2x L80D
TC F8	Tour cover for LVX 8 and FLEXSYS F8	LVX 8 / FLEXSYS F8
TC F10	Tour cover for LVX 10 and FLEXSYS F10	LVX 10 / FLEXSYS F10
TC F12	Tour cover for LVX 12 and FLEXSYS F12	LVX 12 / FLEXSYS F12
TC F15	Tour cover for LVX 15 and FLEXSYS F15	LVX 15 / FLEXSYS F5
TC F212	Tour cover for FLEXSYS F212	FLEXSYS F212
TC F315	Tour cover for FLEXSYS F315	FLEXSYS F315
TC-IG1T	Tour cover for IG1T	IG1T
TC-IG2T	Tour cover for IG2T	IG2T
TC-IG3T	Tour cover for IG3T	IG3T
TC-IG4T	Tour cover for IG4T	IG4T
TC R4	Tour cover for Ready 4	READY 4

Accessories

	Description	Designed for
TC S05D	Tour cover for Sub 05D	SUB 05 D
TC S12D	Tour cover for Sub 12D	SUB 12 D
TC S15D	Tour cover for Sub 15D	SUB 15 D
TC S18D	Tour cover for Sub 18D	SUB 18 D
TC S28D	Tour cover for Sub 28D	SUB 28D
TC-S615	Tour cover for SUB 615	SUB 615
TC-S618	Tour cover for SUB 618	SUB 618
TC S808D	Tour cover for Sub 808D	SUB 808D
TC S15H	Tour cover for SUB 15H	SUB 15H
TC S18H	Tour cover for SUB 18H	SUB 18H
TC SW15	Tour cover for Arena Subs SW15 - SW15PRO	ARENA SW 15 / ARENA SW15 PRO
TC SW18	Tour cover for Arena Subs SW18 - SW18PRO	ARENA SW 18 / ARENA SW18 PRO
TT 06	Cover for K-Series speakers	K 162 / K 300
TT OP08	Tour cover for Opera 508DX	OPERA 508 DX
TT OP10	Tour cover for Opera DX 10" models	OPERA DX 10" Models
TT OP25	Tour cover for Opera DX 12" - 15" models	OPERA DX 12" Models / OPERA 15" Models

CABLES

	Description	Designed for
AFL 05	PowerCon-PowerCon link cable. 1.5m length. Used to link Sigma SUB > Sigma Top; SUB 18D > F212; SUB 15D > F212	SIGMA S115 / S115F / S118 / S215 / S218
C-01	PowerCon-Out cable IEC, 2m [6.56 feet]	All speakers with PowerCon mains input
C-02	Mains cable, 10m [32.8 feet]	All speakers with PowerCon mains input
DCK-4P	Kit composed by 2x speakon cables (4 p), 7m [23 feet]	ES 503 / ES 1203
DAC-70	XLR-XLR Audio Cable (70cm)	IG1T / IG2T
DAC-100	XLR-XLR Audio Cable (100cm)	IG3T / IG4T
DPC-240A	PowerCon Gray Link-PowerCon TRUE1 In Link cable use to link SUB-15H/18H to Ingenia Series (240 cm)	All SUB-H MODELS with all INGENIA MODELS
DPTC-1000M	Mains power cable with PowerCon TRUE1 (10m)	All INGENIA MODELS
DPTC-120L	PowerCon TRUE1-PowerCon TRUE1 Link cable (120cm)	IG1T / IG2T
DPTC-170L	PowerCon TRUE1-PowerCon TRUE1 Link cable (170cm)	IG3T / IG4T

Accessories

INSTALLATION

ARENA WALLBRACKETS

WB A8



Description

"U" Wall mount bracket for Arena 8

Designed for

ARENA 8

WB A10



Description

"U" Wall mount bracket for Arena 10

Designed for

ARENA 10

WB A12



Description

"U" Wall mount bracket for Arena 12

Designed for

ARENA 12

WB A15



Description

"U" Wall mount bracket for Arena 15

Designed for

ARENA 15

WB A810-WB 06



Description

Adjustable wall-mount bracket with knobs

Designed for

ARENA 8, ARENA 10, CROMO 8+ / 10+

ES ACCESSORIES

DP-ES1203



Description

Designed pole for ES 1203

Designed for

ES 1203

DS-25D



Description

Pole Mount Ø 25mm, adjustable, M20 thread.

Designed for

ES 503

SK-25TT



Description

Kit composed by 2x Tripods (D25mm) + bag

Designed for

ES 503

WB-25V



Description

Wall bracket for ES 503 / 602 / 802 top. It can be used for vertical wall mounting

Designed for

ES 503 / 602 / 802 tops

WB-44



Description

Wall bracket for ES 1203 top.

Designed for

ES 1203 tops

INGENIA ACCESSORIES

DRK-IG



Description

Flybar for INGENIA Series

Designed for

IG1T / IG2T / IG3T / IG4T

GSA-IG



Description

Adapter for ground-stacking INGENIA speakers on dBTechnologies subwoofers

Designed for

IG1T / IG2T / IG3T / IG4T

GSA-IGA



Description

Adjustable adapter for ground-stacking INGENIA speakers on dBTechnologies subwoofers

Designed for

IG1T / IG2T / IG3T / IG4T

LP-IG



Description

Link bracket for INGENIA Series. Sold in pairs

Designed for

IG1T / IG2T / IG3T / IG4T

M10B-IG1T

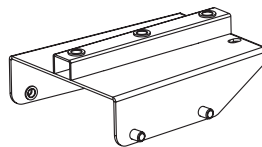

Description

M10/Spigot bracket for IG1T

Designed for

IG1T

STA-IG



Description

Spigot truss adapter for INGENIA Series

Designed for

IG1T / IG2T / IG3T / IG4T

TA-IG



Description

Adapter for attaching DRK-IG and INGENIA speakers to stage trusses

Designed for

DRK-IG

WB-IG14



Description

Wall bracket for mounting IG1T or IG4T, 1 or 2 coupled speakers vertically, only 1 horizontally

Designed for

IG1T / IG4T

WB-IG2



Description

Wall bracket for mounting IG2T, 1 or 2 coupled speakers vertically, only 1 horizontally

Designed for

IG2T

LVX BRACKETS

WB-L8H



Description

Horizontal wall mounting bracket for LVX 8. White available

Designed for

LVX 8, FLEXSYS F8

WB-L10H



Description

Horizontal wall mounting bracket for LVX 10. White available

Designed for

LVX 10, FLEXSYS F10

WB-L12H



Description

Horizontal wall mounting bracket for LVX 12. White available

Designed for

LVX 12, FLEXSYS F12

Accessories

WB-L15H



Description

Horizontal wall mounting bracket for LVX 15. White available

Designed for

LVX 15, FLEXSYS F15

WB-L8V

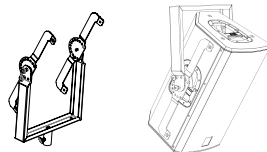

Description

Vertical wall mounting bracket for LVX 8. White available

Designed for

LVX 8, FLEXSYS F8

WB-L10V

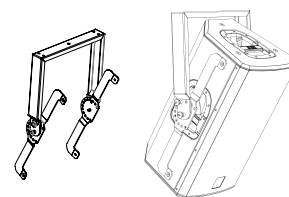

Description

Vertical wall mounting bracket for LVX 10. White available

Designed for

LVX 10, FLEXSYS F10

WB-L12V

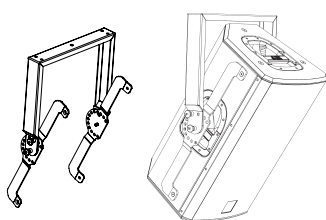

Description

Vertical wall mounting bracket for LVX 12. White available

Designed for

LVX 12, FLEXSYS F12

WB-L15V

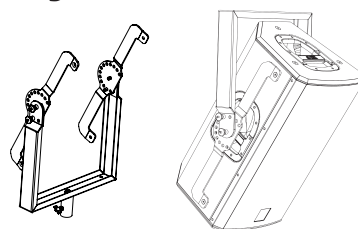

Description

Vertical wall mounting bracket for LVX 15. White available

Designed for

LVX 15, FLEXSYS F15

MINIBOX ACCESSORIES

AK 50



Description

Removable handle for MINIBOX K162 and K300

Designed for

K 162 / K 300

SA25



Description

D25mm speaker stand adaptor for MINIBOX Series. Tilt adjustable gear and locking screw

Designed for

L 80D / L 160D / K 70 / K 162 / K 300

SN 130



Description

MINIBOX adapter for Microphone stands

Designed for

L 80D / L 160D / K 70 / K 162 / K 300

WB 03 & WB 03W



Description

Swivel and tilt wall-mount bracket for MINIBOX Series. White available

Designed for

L 80D / L 160D / K 70 / K 162 / K 300

WB 11



Description

Universal wall mount bracket for MINIBOX Series

Designed for

L 80D / L 160D / K 70 / K 162 / K 300

OPERA BRACKETS

WB-OP10

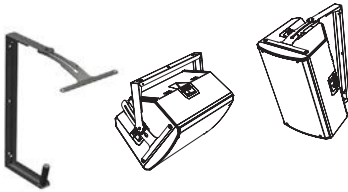

Description

Horizontal/Vertical wall bracket

Designed for

OPERA 10

WB-OP12

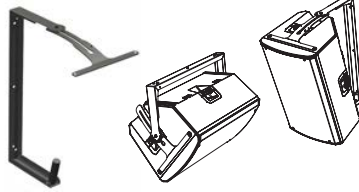

Description

Horizontal/Vertical wall bracket

Designed for

OPERA 12

WB-OP15

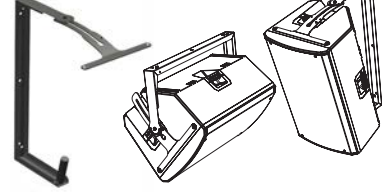

Description

Horizontal/Vertical wall bracket

Designed for

OPERA 15

WB D10



Description

Wall bracket "U" shaped, for wall or truss mounting, either vertically or horizontally

Designed for

For all Opera DX and BL 10"

WB D25



Description

Wall bracket "U" shaped, for wall or truss mounting, either vertically or horizontally

Designed for

For all Opera DX and BL 12" and 15" models

MISCELLANEOUS

AFL 01



Description

Speaker pole for SUB D, Ø 35mm, adjustable

Designed for

SUB 05 D / SUB 12 D / SUB 28D / SUB 808D

BP-M20

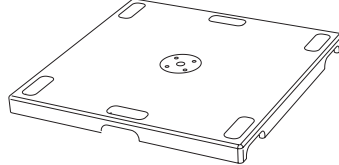

Description

Base plate for securing SIGMA S218, with M20

Designed for

SIGMA S218

DS-2



Description

Pole Mount Ø 35mm, adjustable, M20 thread

Designed for

SUBs H / ARENA SW 15 / ARENA SW 18

DS2-S



Description

Pole Mount M20 thread, 20cm length

Designed for

SUB 15H / SUB 18H / SUB 615 / SUB 618

SK-36TT



Description

Kit composed by 2x Tripods (D35mm) + bag

Designed for

All speakers with D36mm pole mount cup

TE M8



Description

Eye-bolt set (4 pcs) with M8-thread

Designed for

ARENA 8 / 10, LVX 8 / 10

Accessories

TE M10



Description

Eye-bolt set (4 pcs) with M10-thread

Designed for

SIGMA S115F, ARENA 12 / 15, FLEXSYS F212/ F315, LVX 12 / 15

WB 09



Description

Universal wall mount bracket, swivel and tilt Ø35mm pole mount

Designed for

All speakers with Ø 36mm pole mount cup

TRANSPORT

DO-ES1203



Description

Magnetic transport dolly for ES 1203

Designed for

ES 1203

DT-50



Description

Trolley for ES 503 and SUB 28D + 2x L160D

Designed for

ES 503 / SUB 28D + 2x L160D

SWK-18 KIT



Description

Kit composed by 4x 100mm wheels for SUB18D

Designed for

SUB 18D

BUNDLES

Stereo Kit ES503

Description	Designed for
Kit composed by 2x tripods + bag for tripods + 2x 7m speakon cables	ES 503
Transport kit composed by bag for L160D, bag for SUB 28D and DT-50 trolley	SUB 28D, L160D
Transport kit composed by bag for ES 503 tops, bag for ES 503 sub and DT-50 trolley	ES 503

TK-160+28

TK-ES12



See also the **Rental & Installation 2017** catalogue

Find all products datasheets on
www.dbtechnologies.com

Features, specification and appearance of products are subject to change without notice. dBTechnologies reserves the right to make changes or improvements in design or manufacturing without assuming any obligation to change or improve products previously manufactured.

dBTechnologies

Italy & International sales

AEB Industriale Srl

Via Brodolini, 8 - Loc. Crespellano

40053 Valsamoggia (BO) ITALY

Tel +39 051 96 98 70

Fax +39 051 96 97 25

info@dbtechnologies-aeb.com

dBTechnologies Deutschland GmbH

Germany, Belgium, Netherlands, Luxembourg, Austria

Hansestrasse 93

51149 Köln

Tel. +49 (0)2203 925370

Fax. +49 (0)2203 9253773

verkauf@dbtechnologies.de

**dBTechnologies**

www.dbtechnologies.com